

EXHIBITS



LIST OF EXHIBITS

1. General Plan -- Site Y-15 - New Mexico
2. Ownership, Hydrology, Drainage and Test Boring Locations --
Site Y-15 - New Mexico
3. Plan and Profile - North Branch Site Y-15 - New Mexico
4. Plan and Profile - North Branch Site Y-15 - New Mexico
5. Plan and Profile - Southeast Branch Site Y-15 - New Mexico
6. Plan and Profile - Southeast Branch Site Y-15 - New Mexico
7. Plan and Profile - Southwest Branch Site Y-15 - New Mexico
8. Plan and Profile - Southwest Branch Site Y-15 - New Mexico
9. General Plan -- Site Y-23 - Arizona
10. Ownership, Hydrology, Drainage and Test Boring Locations --
Site Y-23 - Arizona
11. Plan and Profile - North Branch Site Y-23 - Arizona
12. Plan and Profile - North Branch Site Y-23 - Arizona
13. Plan and Profile - Southeast Branch Site Y-23 - Arizona
14. Plan and Profile - Southeast Branch Site Y-23 - Arizona
15. Plan and Profile - Southwest Branch Site Y-23 - Arizona
16. Plan and Profile - Southwest Branch Site Y-23 - Arizona
17. Railway Plan and Details
18. Typical Sections
19. Alternate No. 1 and Sections

List of Exhibits (continued)

20. Building Complex Plot Plan
21. Laboratory Building Floor Plans
22. Laboratory Building Elevations and Sections
23. Shops Building, Garages and Central Power Plant --
Plan Elevation and Section
24. Dormitory Building - Plan, Elevation and Section

R 10 W R 9 W

R 9 W R 8 W

R 8 W R 7 W

R 7 W R 6 W

R 6 W R 5 W

T
1
N
T
I
S

T
1
S
T
2
S

T
2
S
T
3
S

T
3
S
T
4
S

T
1
N
T
I
S

T
1
S
T
2
S

T
2
S
T
3
S

T
3
S
T
4
S



NOTE: BASE TOPOGRAPHIC INFORMATION OBTAINED FROM PRELIMINARY MAPPING SHEETS BEING PREPARED BY THE U.S.G.S.
 CONTOUR INTERVAL 10' @ 20'

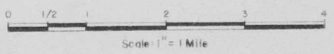

- ☼ - WATER WELLS
- ☐ - CONSTRUCTION MATERIAL SOURCE
 1, 4, 5 & 6 - GRAVEL; 2 & 3 - ROCK; 7 - CLAY



LIMBAUGH ENGINEERS, INC.
 CONSULTING ENGINEERS and PHOTOGRAMMETRISTS
1221 California Blvd., N.E., P.O. Box 911
 Oklahoma City, Oklahoma 73116

V L A SITE DEVELOPMENT STUDY
 FOR
THE ASSOCIATED UNIVERSITIES, INC.

GENERAL PLAN
 SITE, Y-15, NEW MEXICO

DATE: JULY 1966 SCALE: 1" = 1 MILE **EXHIBIT I**

NOTE: THIS DRAWING IS NOT TO SCALE. IT HAS BEEN REDUCED FROM THE ORIGINAL.

R10W R9W

R9W R8W

R8W R7W

R7W R6W

R6W R5W

T1N
T1S

T1N
T1S

T1S
T2S

T1S
T2S

T2S
T3S

T2S
T3S

T3S
T4S

T3S
T4S

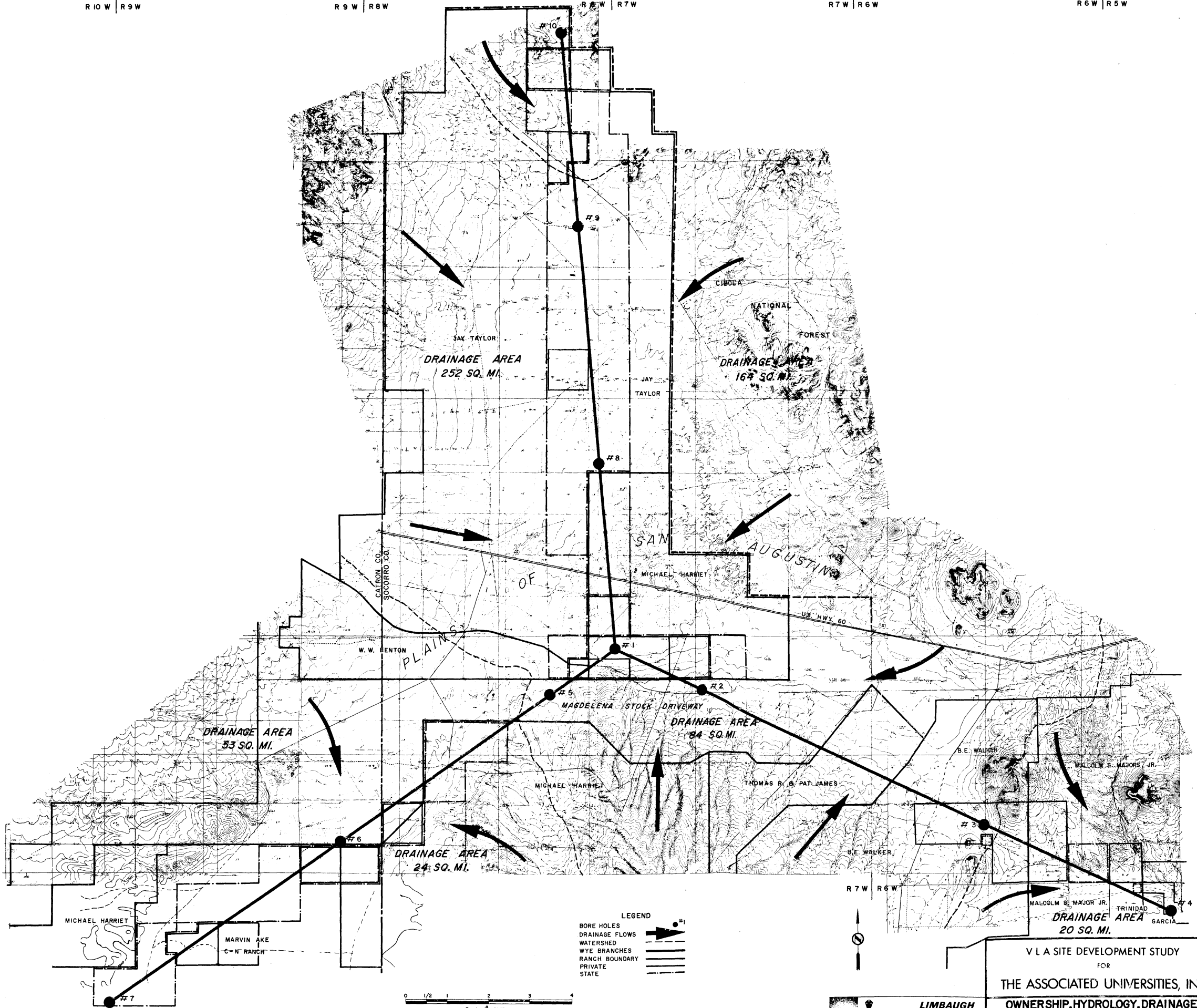

LEGEND

- BORE HOLES
- DRAINAGE FLOWS
- WATERSHED
- WYE BRANCHES
- RANCH BOUNDARY
- PRIVATE STATE

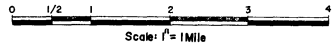

R10W R9W

R9W R8W

R8W R7W

R7W R6W

V L A SITE DEVELOPMENT STUDY
FOR
THE ASSOCIATED UNIVERSITIES, INC.
**OWNERSHIP, HYDROLOGY, DRAINAGE
& TEST BORING LOCATIONS**
SITE, Y-15, NEW MEXICO



DATE: JULY 1966 SCALE: 1" = 1 MILE **EXHIBIT 2**

NOTE: THIS DRAWING IS NOT TO SCALE, IT HAS BEEN REDUCED FROM THE ORIGINAL.



| | | | |
|---------------|--------------------|----|------|
| PLAN | SURVEYED | BY | DATE |
| | PLANNED | | |
| NOTE BOOK NO. | CHECKED | | |
| | RT. OF WAY CHECKED | | |

| | | | |
|---------------|-----------------------------|----|------|
| PROFILE | SURVEYED | BY | DATE |
| | PLOTTED | | |
| NOTE BOOK NO. | CHECKED | | |
| | STRUCTURE NOTATIONS CHECKED | | |

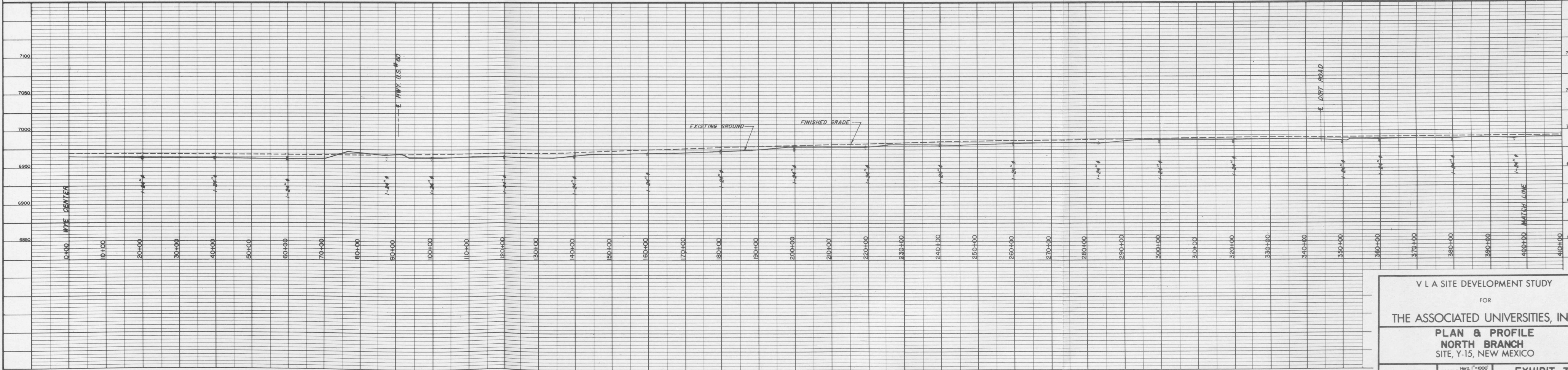

V L A SITE DEVELOPMENT STUDY
 FOR
 THE ASSOCIATED UNIVERSITIES, INC.
PLAN & PROFILE
 NORTH BRANCH
 SITE, Y-15, NEW MEXICO

DATE: SEPT. 1966 SCALE: Horiz. 1" = 1000'
 Vert. 1" = 50'

EXHIBIT 3

NOTE: THIS DRAWING IS NOT TO SCALE, IT HAS BEEN REDUCED FROM THE ORIGINAL.

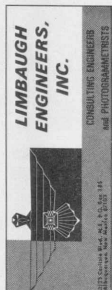

| | |
|-----------|--|
| DATE | |
| BY | |
| PROFILE | |
| SURVEYED | |
| PLOTTED | |
| NOTE BOOK | |
| NO. | |

| | |
|-----------|--|
| DATE | |
| BY | |
| PLAN | |
| SURVEYED | |
| PLOTTED | |
| NOTE BOOK | |
| NO. | |

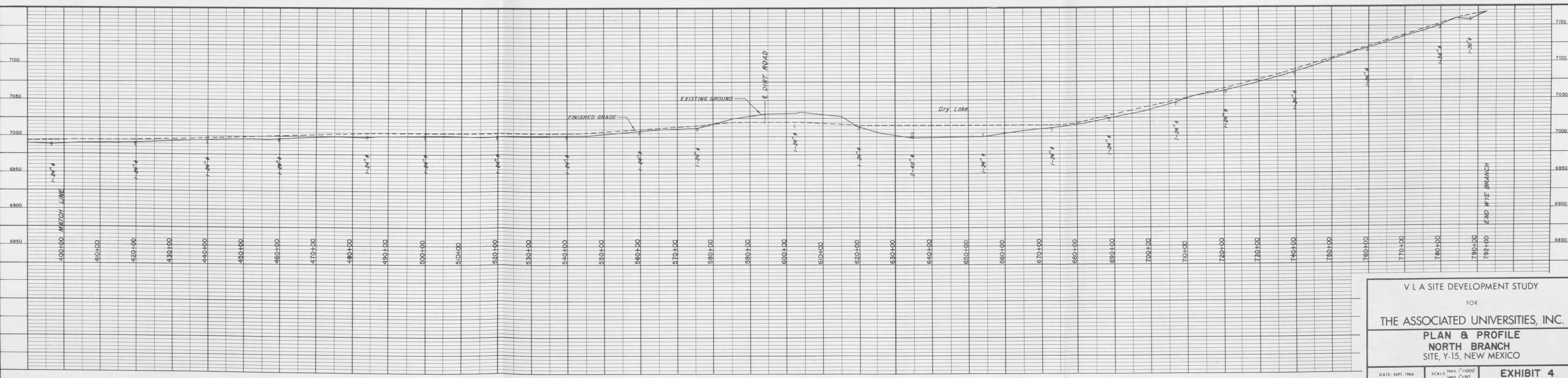

V L A SITE DEVELOPMENT STUDY
FOR
THE ASSOCIATED UNIVERSITIES, INC.
PLAN & PROFILE
NORTH BRANCH
SITE, Y-15, NEW MEXICO

DATE: SEPT. 1966 SCALE: Horiz. 1"=1000' EXHIBIT 4
Vert. 1"=50'

NOTE: THIS DRAWING IS NOT TO SCALE, IT HAS BEEN REDUCED FROM THE ORIGINAL.

| | | | |
|------|------------------------|----|------|
| PLAN | SURVEYED | BY | DATE |
| | PLOTTED | | |
| | NOTE BOOK | | |
| | NO. _____ | | |
| | STRUCTURE NOT AS SHOWN | | |

| | | | |
|---------|------------------------|----|------|
| PROFILE | SURVEYED | BY | DATE |
| | PLOTTED | | |
| | NOTE BOOK | | |
| | NO. _____ | | |
| | STRUCTURE NOT AS SHOWN | | |

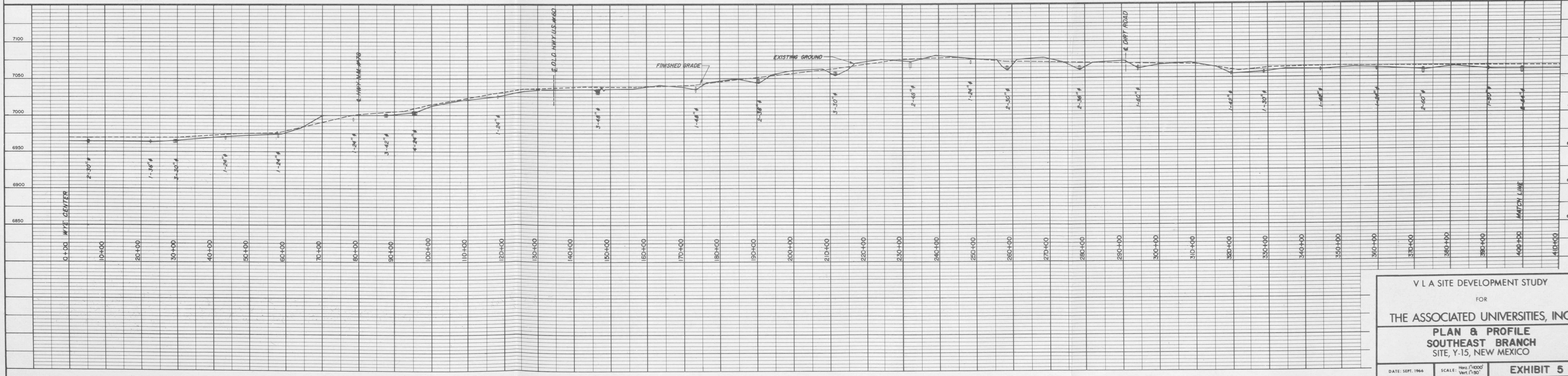
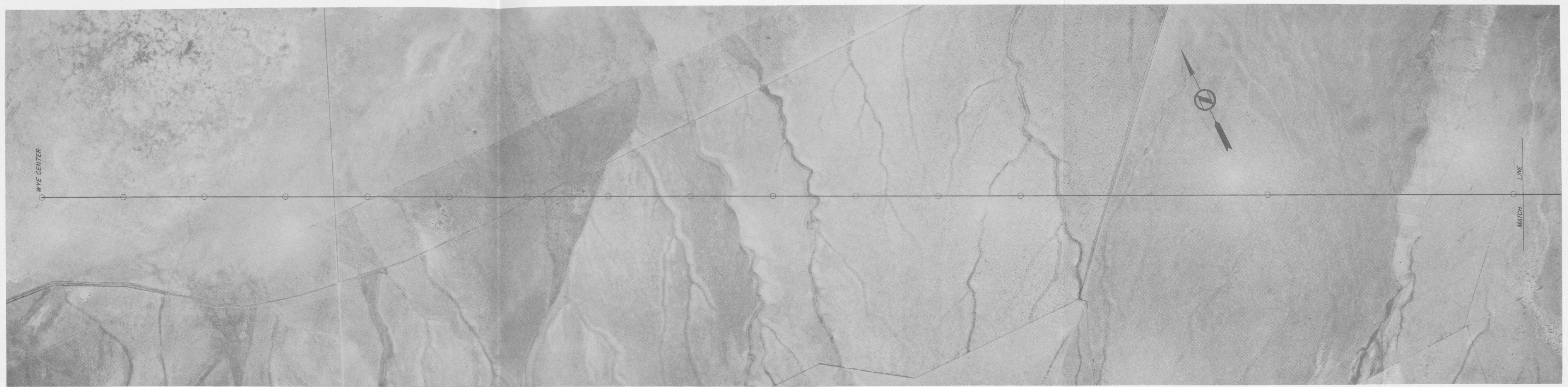
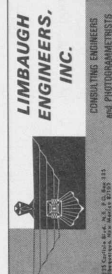

V L A SITE DEVELOPMENT STUDY
 FOR
 THE ASSOCIATED UNIVERSITIES, INC.
 PLAN & PROFILE
 SOUTHEAST BRANCH
 SITE, Y-15, NEW MEXICO

DATE: SEPT. 1964 SCALE: Horiz. 1"=100' VERT. 1"=50' EXHIBIT 5

NOTE: THIS DRAWING IS NOT TO SCALE, IT HAS BEEN REDUCED FROM THE ORIGINAL.

| | | | |
|------|----------|----|------|
| PLAN | SURVEYED | BY | DATE |
| | NOTED | | |
| | ALIGNED | | |
| | CHECKED | | |
| | BY | | |
| | NO. | | |

| | | | |
|---------|----------|----|------|
| PROFILE | SURVEYED | BY | DATE |
| | NOTED | | |
| | CHECKED | | |
| | BY | | |
| | NO. | | |

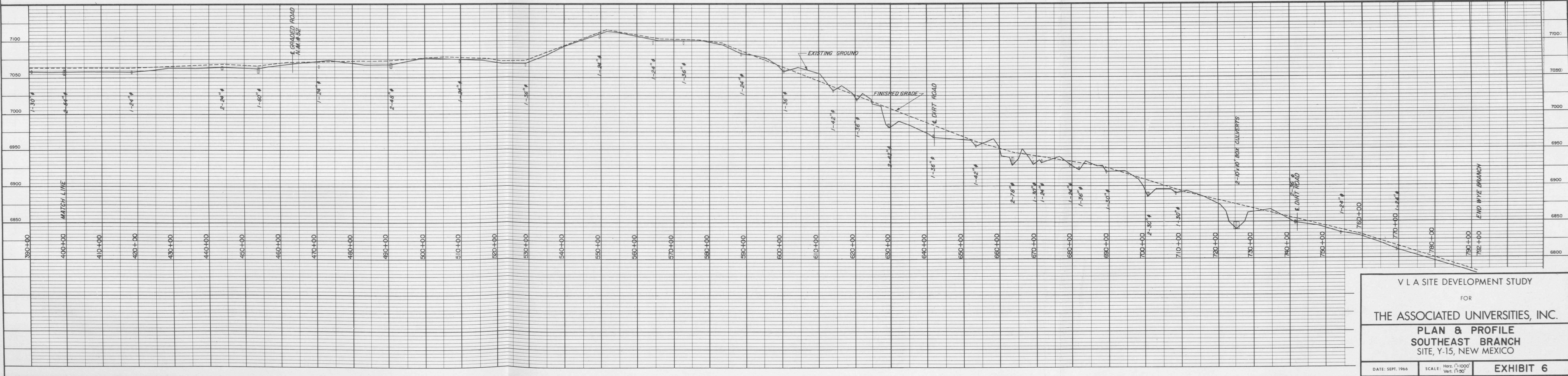
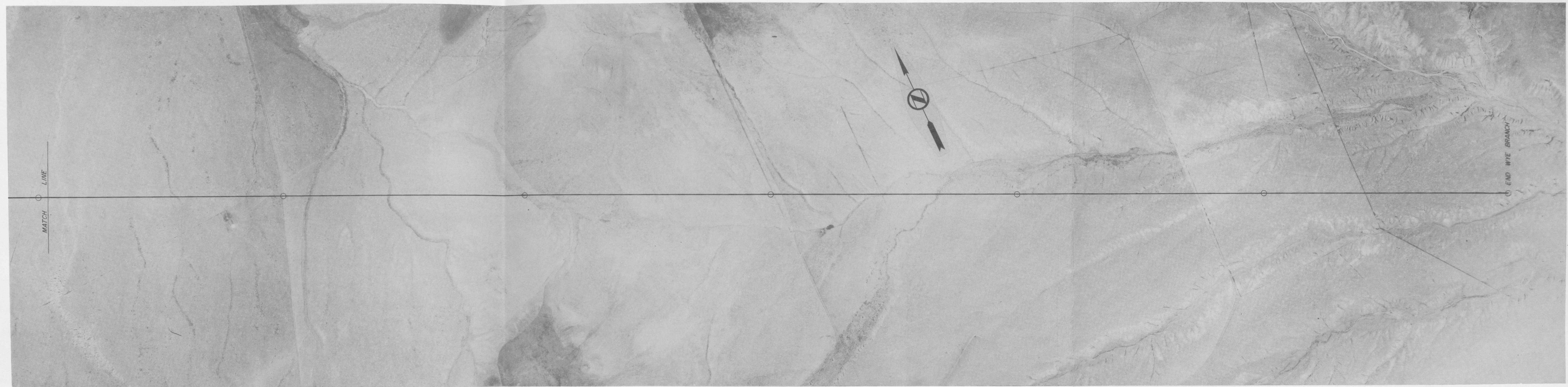

V L A SITE DEVELOPMENT STUDY
FOR
THE ASSOCIATED UNIVERSITIES, INC.
PLAN & PROFILE
SOUTHEAST BRANCH
SITE, Y-15, NEW MEXICO

DATE: SEPT. 1966 SCALE: Horiz. 1"=1000' Vert. 1"=50' **EXHIBIT 6**

NOTE: THIS DRAWING IS NOT TO SCALE. IT HAS BEEN REDUCED FROM THE ORIGINAL.

| | | | |
|------|-------------------|----|------|
| PLAN | DESIGNED | BY | DATE |
| | PLOTTED | | |
| | ALIGNMENT CHECKED | | |
| | RT OF WAY CHECKED | | |
| | NO. | | |

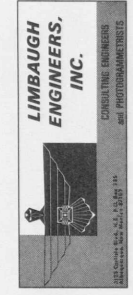

| | | | |
|---------|--------------------------|----|------|
| PROFILE | SURVEYED | BY | DATE |
| | GRADES CHECKED | | |
| | B.M.'S NOTED | | |
| | STRUCTURE NOTING CHECKED | | |
| | NO. | | |

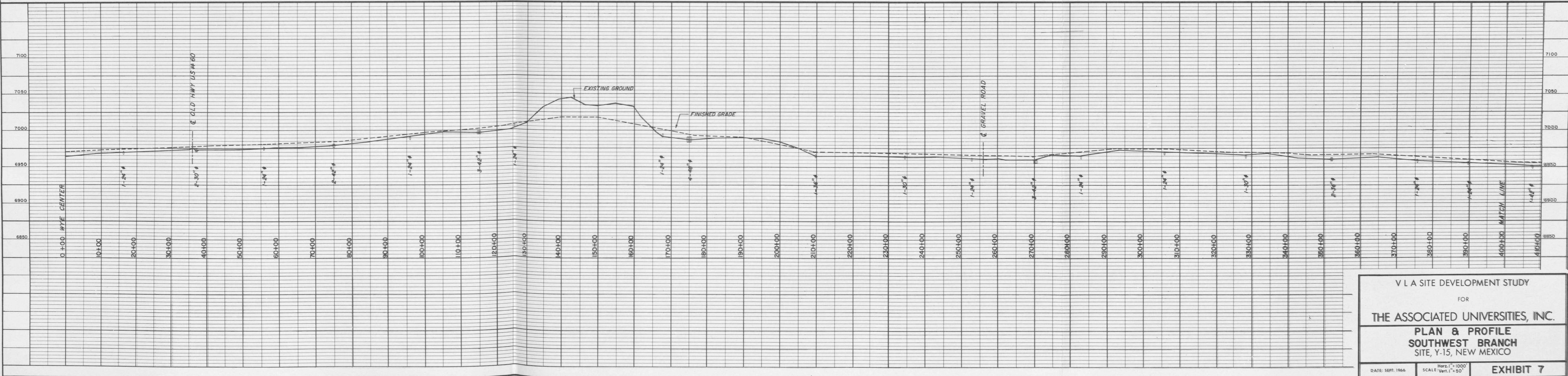

V L A SITE DEVELOPMENT STUDY
 FOR
THE ASSOCIATED UNIVERSITIES, INC.
PLAN & PROFILE
SOUTHWEST BRANCH
SITE, Y-15, NEW MEXICO

DATE: SEPT. 1966 SCALE: Vert. 1" = 50' HORIZ. 1" = 100'
EXHIBIT 7

NOTE: THIS DRAWING IS NOT TO SCALE, IT HAS BEEN REDUCED FROM THE ORIGINAL.



| | | | |
|------|-----------------------------|----|------|
| PLAN | DESIGNED | BY | DATE |
| | PLOTTED | | |
| | NOTE BOOK ALIGNMENT CHECKED | | |
| | RT. OF WAY CHECKED | | |
| | NO. | | |

| | | | |
|---------|-------------------------|----|------|
| PROFILE | SUPPLIED | BY | DATE |
| | PROFILES CHECKED | | |
| | NOTE BOOK 8 M.A. NOTE | | |
| | STRUCTURE NOTATION CHG. | | |
| | NO. | | |

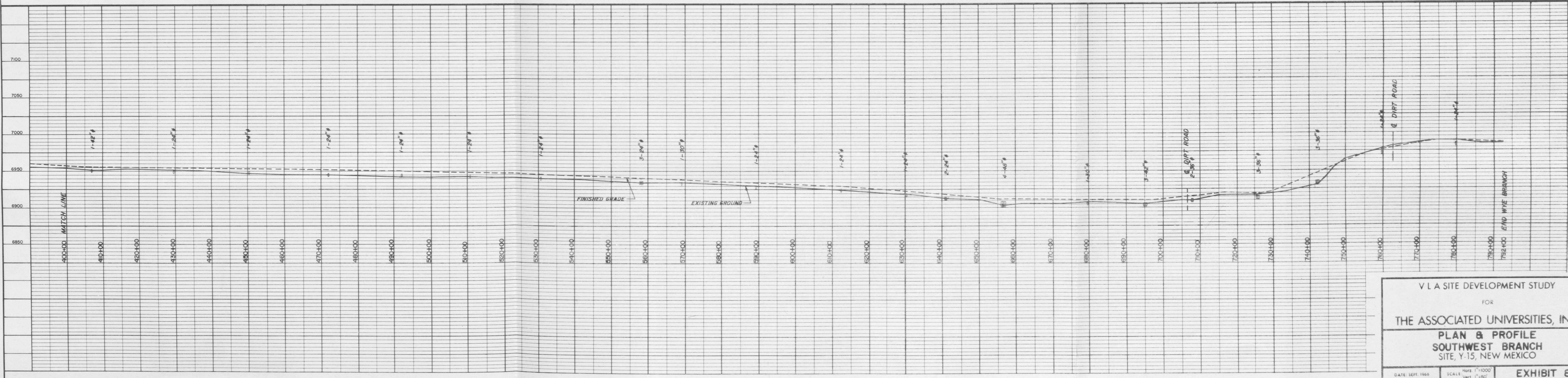
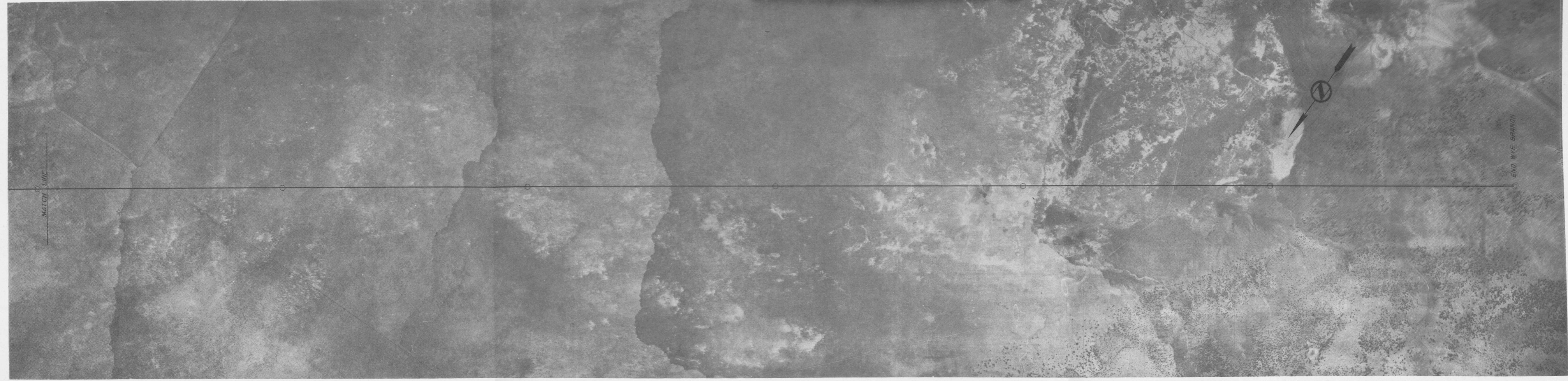

V L A SITE DEVELOPMENT STUDY
 FOR
 THE ASSOCIATED UNIVERSITIES, INC.
PLAN & PROFILE
 SOUTHWEST BRANCH
 SITE, Y-15, NEW MEXICO

DATE: SEPT. 1968 SCALE: Horiz. 1"=1000' VERT. 1"=50'
EXHIBIT 8

NOTE: THIS DRAWING IS NOT TO SCALE. IT HAS BEEN REDUCED FROM THE ORIGINAL.

T 12 S
T 13 S

T 13 S
T 14 S

T 14 S
T 15 S

T 15 S
T 16 S

T 12 S
T 13 S

T 13 S
T 14 S

T 14 S
T 15 S

T 15 S
T 16 S

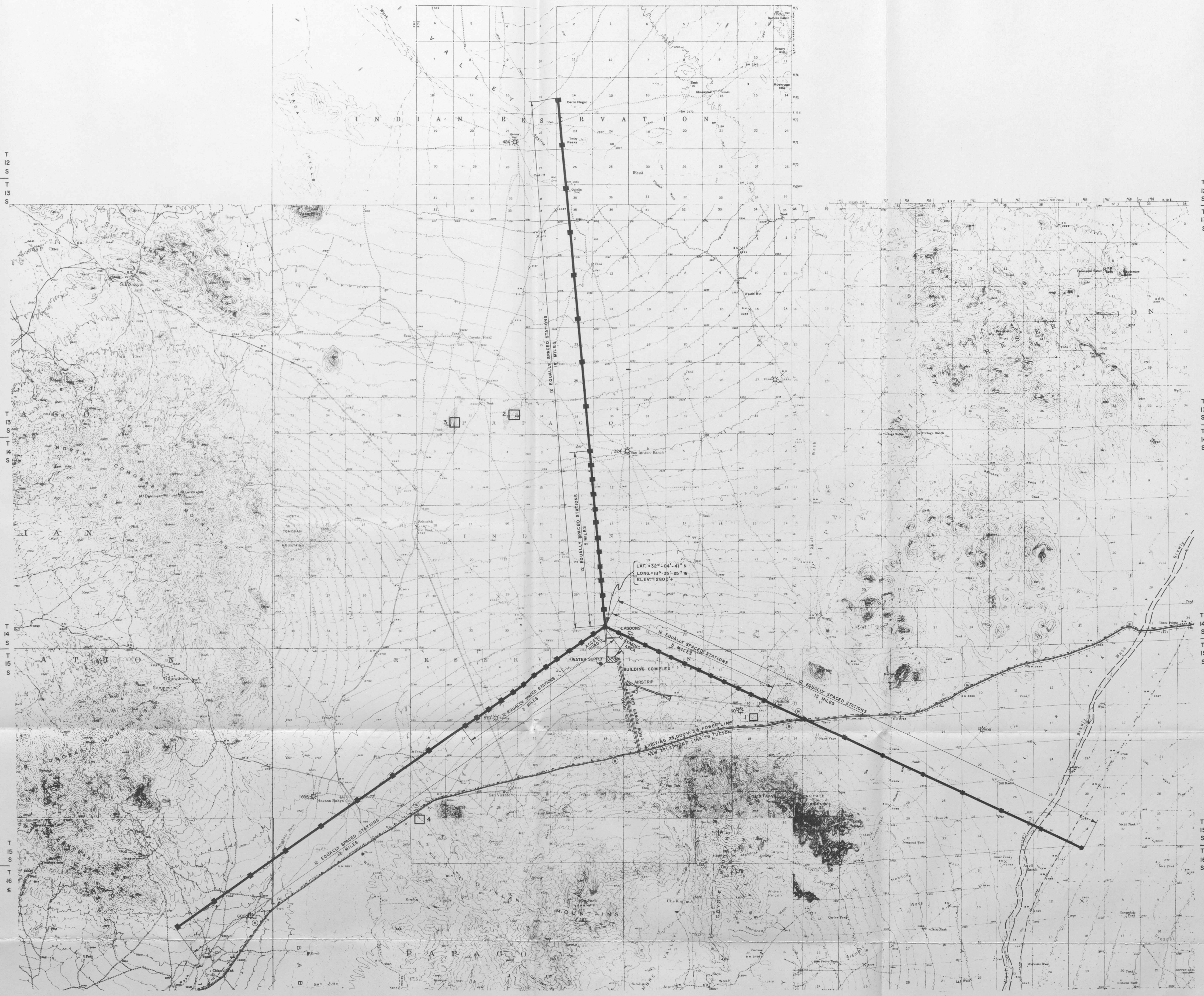

NOTE: BASE TOPOGRAPHIC INFORMATION
OBTAINED FROM U.S.G.S. MAPS

- ☼ - WATER WELLS & DEPTHS TO WATER
- - CONSTRUCTION MATERIAL SOURCE
1, 2, 3 - ROCK, 4 - GRAVEL

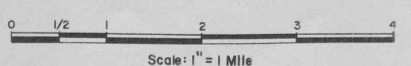

V L A SITE DEVELOPMENT STUDY
FOR
THE ASSOCIATED UNIVERSITIES, INC.

GENERAL PLAN
SITE, Y-23, ARIZONA

DATE: JULY 1966 SCALE: 1" = 1 MILE EXHIBIT 9

NOTE: THIS DRAWING IS NOT TO SCALE. IT HAS BEEN REDUCED FROM THE ORIGINAL.

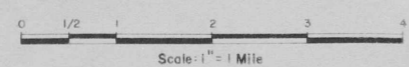
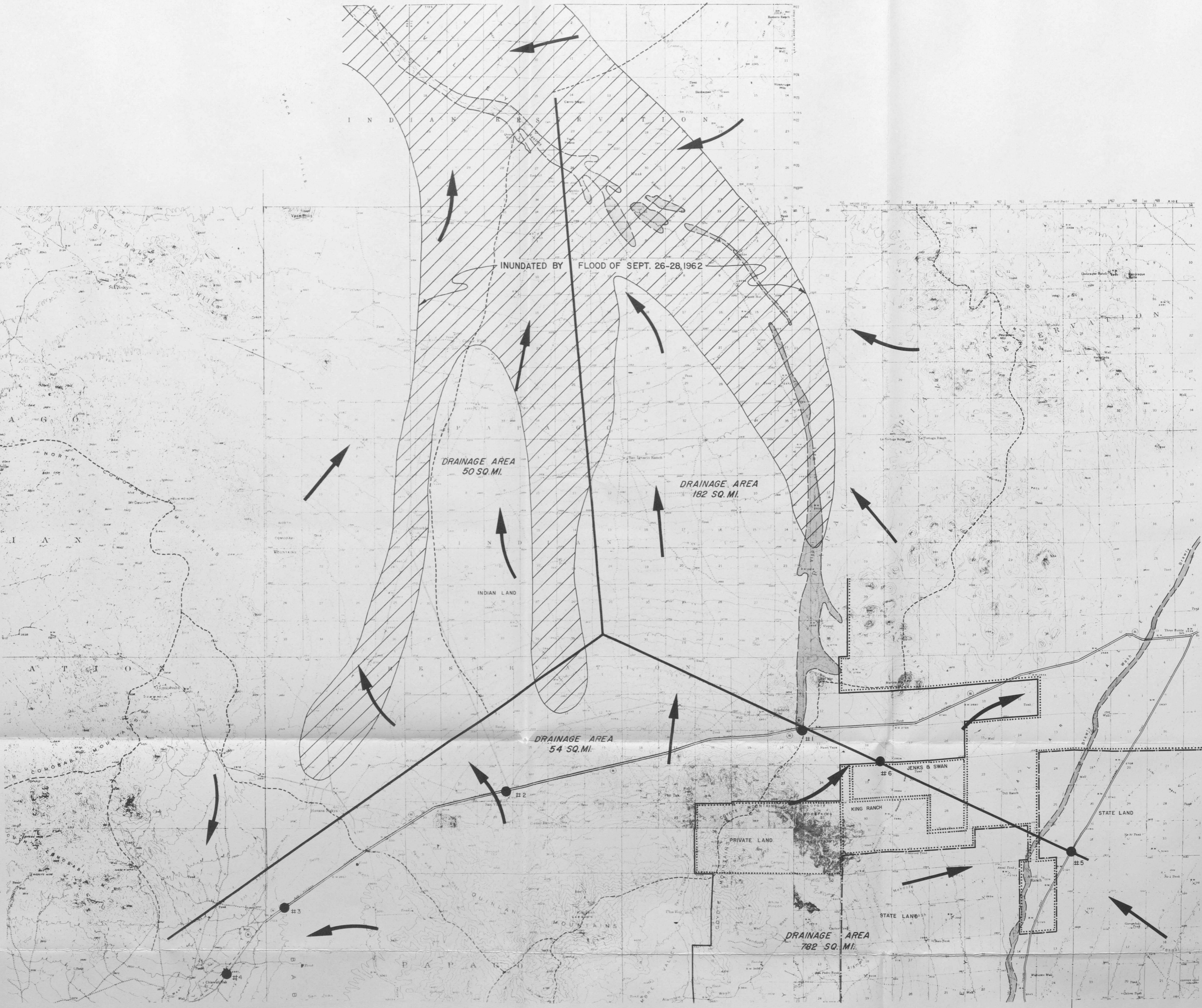

LEGEND

- BORE HOLES ● #2
- DRAINAGE FLOWS →
- WATERSHED ———
- WYE BRANCHES ———
- INDIAN LAND - - - - -
- PRIVATE LAND ·····
- STATE LAND ———
- MAJOR WASH OR ARROYO AREA □

V L A SITE DEVELOPMENT STUDY
FOR
THE ASSOCIATED UNIVERSITIES, INC.
OWNERSHIP, HYDROLOGY, DRAINAGE
& TEST BORING LOCATIONS
SITE, Y-23, ARIZONA

DATE: JULY 1968 SCALE: 1" = 1 MILE EXHIBIT 10



NOTE: THIS DRAWING IS NOT TO SCALE, IT HAS BEEN REDUCED FROM THE ORIGINAL.

| | | |
|------|--------------------|------|
| PLAN | DESIGNED | DATE |
| | PLOTTED | BY |
| | ALIGNMENT CHECKED | |
| | RT. OF WAY CHECKED | |
| NO. | | |

| | | |
|---------|-------------------------|------|
| PROFILE | DESIGNED | DATE |
| | PLOTTED | BY |
| | GRADE CHECKED | |
| | STRUCTURE NOT IN CHARGE | |
| NO. | | |

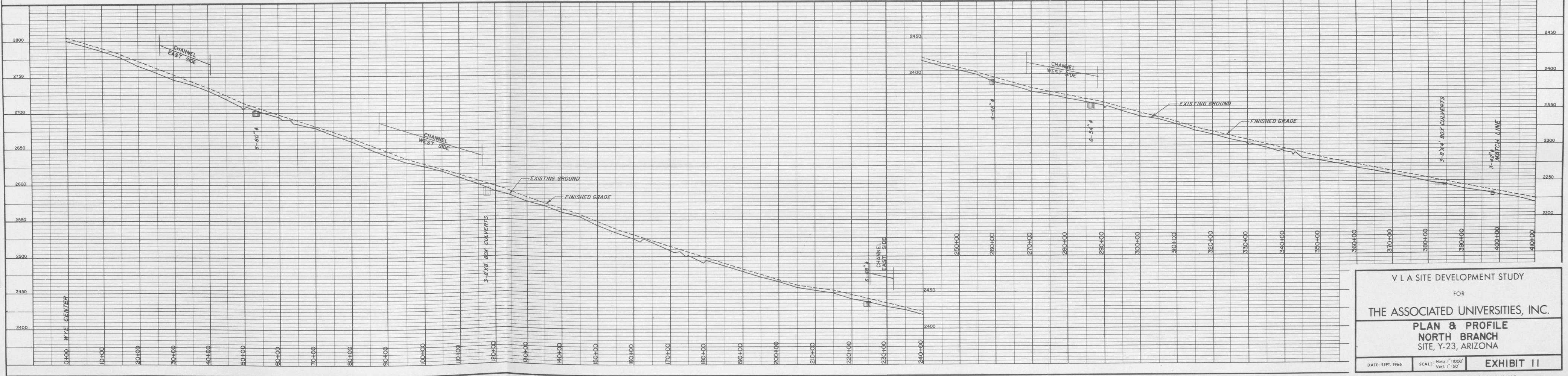

V L A SITE DEVELOPMENT STUDY
 FOR
THE ASSOCIATED UNIVERSITIES, INC.
PLAN & PROFILE
NORTH BRANCH
SITE, Y-23, ARIZONA

DATE: SEPT. 1966 SCALE: Horiz. 1"=1000' Ver. 1"=50' **EXHIBIT II**

NOTE: THIS DRAWING IS NOT TO SCALE. IT HAS BEEN REDUCED FROM THE ORIGINAL.

| | | | |
|------|--------------------|----|------|
| PLAN | SUBJECT | BY | DATE |
| | PLOTTED | | |
| | ALIGNMENT CHECKED | | |
| | NO. OF PLS CHECKED | | |

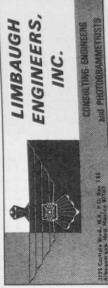

| | | | |
|---------|---------------------------|----|------|
| PROFILE | SUBJECT | BY | DATE |
| | PLOTTED | | |
| | GRADES CHECKED | | |
| | STRUCTURE NOTATIONS CHKD. | | |

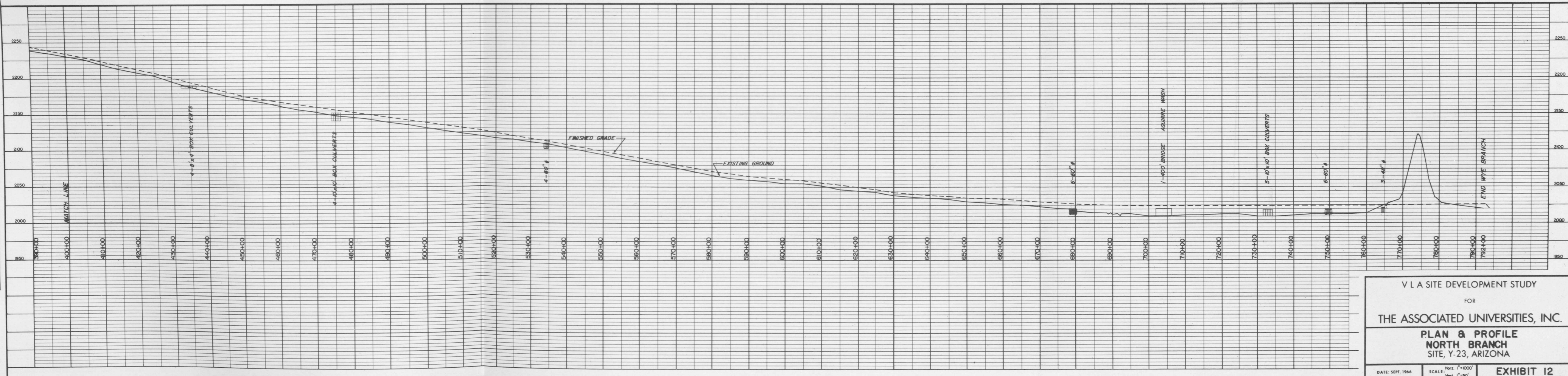
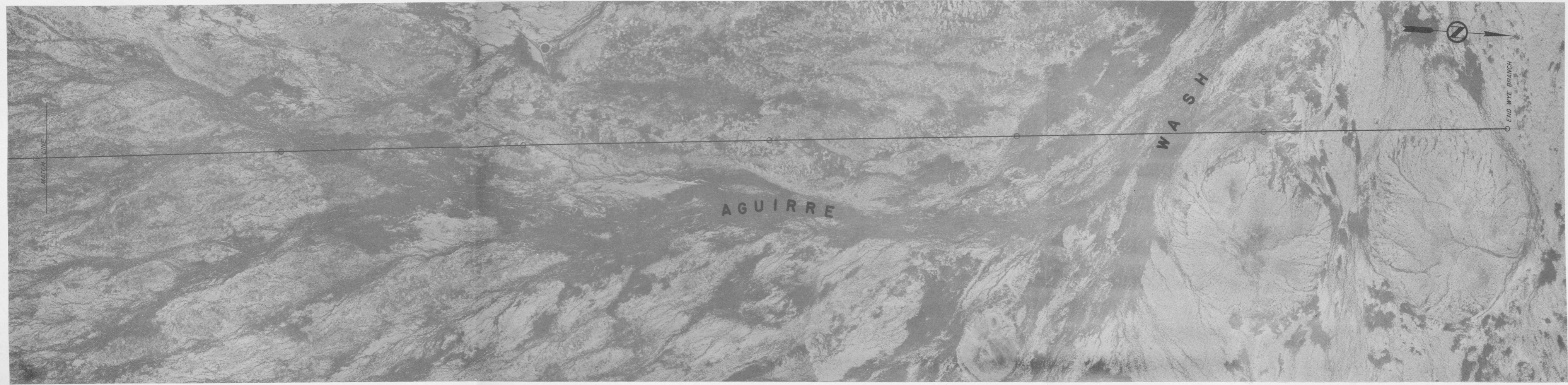

V L A SITE DEVELOPMENT STUDY
 FOR
 THE ASSOCIATED UNIVERSITIES, INC.
PLAN & PROFILE
NORTH BRANCH
 SITE, Y-23, ARIZONA

DATE: SEPT. 1966 SCALE: Horz. 1"=1000' VERT. 1"=50' **EXHIBIT 12**

NOTE: THIS DRAWING IS NOT TO SCALE, IT HAS BEEN REDUCED FROM THE ORIGINAL.

| | |
|------|------|
| PLAN | DATE |
| NO. | |
| BY | |
| DATE | |
| BY | |
| DATE | |
| BY | |
| DATE | |
| BY | |
| DATE | |

| | |
|---------|------|
| PROFILE | DATE |
| NO. | |
| BY | |
| DATE | |
| BY | |
| DATE | |
| BY | |
| DATE | |
| BY | |
| DATE | |

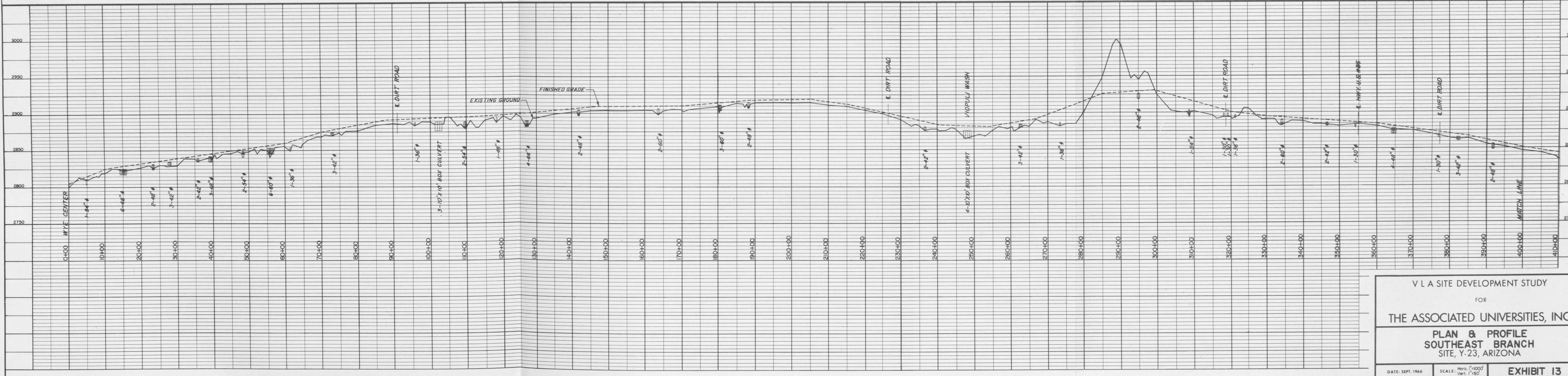
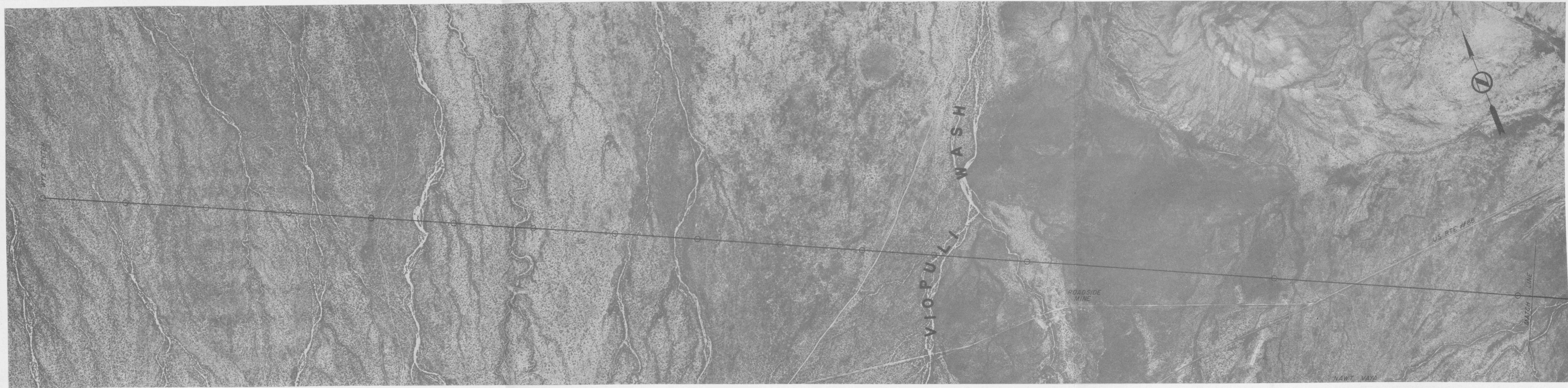

V L A SITE DEVELOPMENT STUDY
 FOR
 THE ASSOCIATED UNIVERSITIES, INC.
 PLAN & PROFILE
 SOUTHEAST BRANCH
 SITE, Y-23, ARIZONA

DATE: SEPT. 1966 SCALE: Horiz. 1"=100'
 Vert. 1"=50' EXHIBIT 13

NOTE: THIS DRAWING IS NOT TO SCALE, IT HAS BEEN REDUCED FROM THE ORIGINAL.

| | | | |
|------|---------------------|----|------|
| PLAN | SURVEYED | BY | DATE |
| NO. | NOTE BOOK | | |
| | ALIGNMENT CHECKED | | |
| | BY | | |
| | NO. OF WALS CHECKED | | |

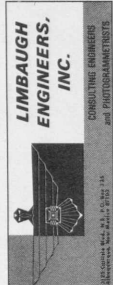

| | | | |
|---------|---------------------------|----|------|
| PROFILE | SURVEYED | BY | DATE |
| NO. | NOTE BOOK | | |
| | GRADES CHECKED | | |
| | BY | | |
| | STRUCTURE NOTATIONS CHKD. | | |

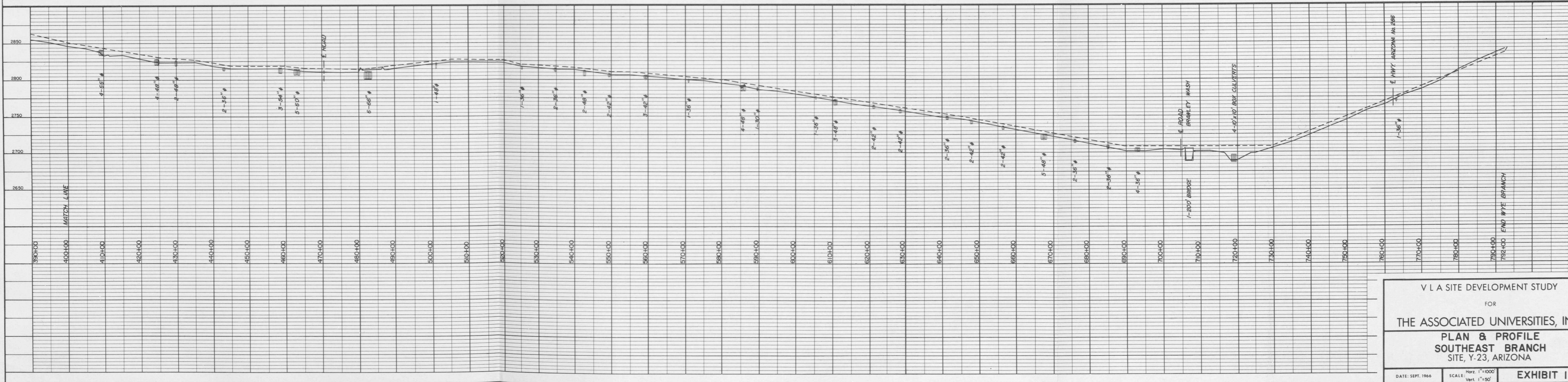
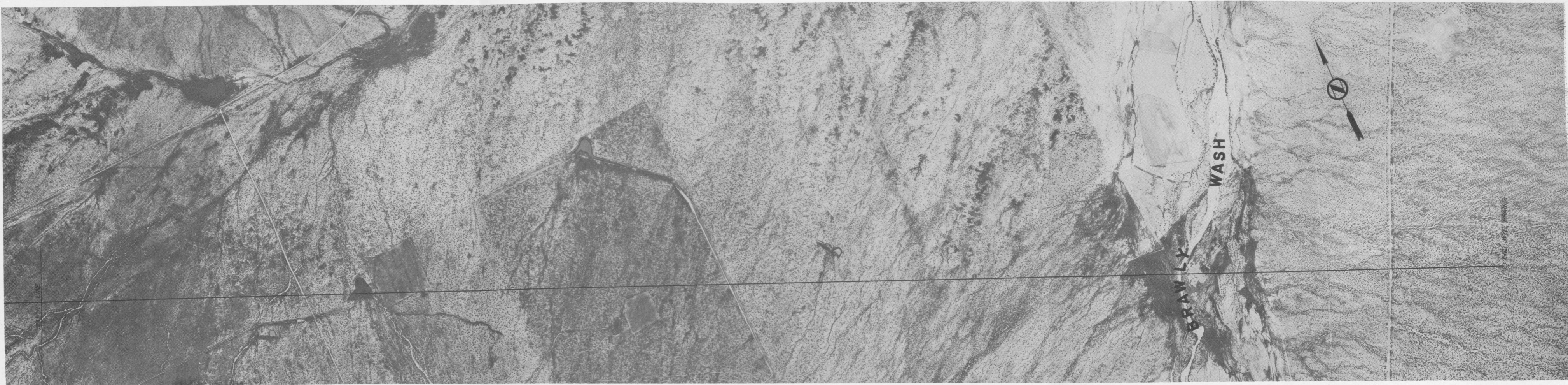

V L A SITE DEVELOPMENT STUDY
 FOR
 THE ASSOCIATED UNIVERSITIES, INC.
 PLAN & PROFILE
 SOUTHEAST BRANCH
 SITE, Y-23, ARIZONA

DATE: SEPT. 1966 SCALE: Horz. 1"=1000' EXHIBIT 14
 Vert. 1"=50'

NOTE: THIS DRAWING IS NOT TO SCALE. IT HAS BEEN REDUCED FROM THE ORIGINAL.

PLAN
 SURVEYED _____
 PLOTTED _____
 NOTE BOOK GRADES CHECKED _____
 NO. _____
 BY _____
 DATE _____

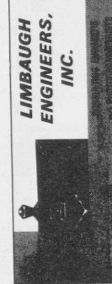

PROFILE
 SURVEYED _____
 PLOTTED _____
 NOTE BOOK GRADES CHECKED _____
 NO. _____
 BY _____
 DATE _____

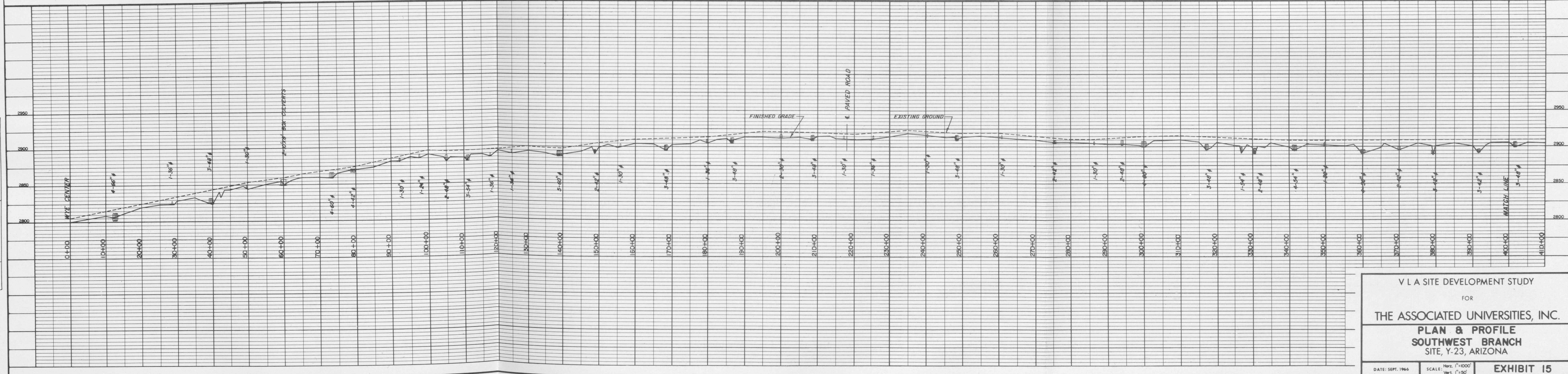

V L A SITE DEVELOPMENT STUDY
 FOR
THE ASSOCIATED UNIVERSITIES, INC.
PLAN & PROFILE
SOUTHWEST BRANCH
 SITE, Y-23, ARIZONA

DATE: SEPT. 1966 SCALE: Hor. 1"=1000' VERT. 1"=50' **EXHIBIT 15**

NOTE: THIS DRAWING IS NOT TO SCALE, IT HAS BEEN REDUCED FROM THE ORIGINAL.

| | | | |
|------|--------------------|----|------|
| PLAN | SURVEYED | BY | DATE |
| | PLOTTED | | |
| | CHECKED | | |
| | RT. OF WAY CHECKED | | |
| | NO. | | |

| | | | |
|---------|--------------------|----|------|
| PROFILE | SURVEYED | BY | DATE |
| | PLANNED | | |
| | CHECKED | | |
| | RT. OF WAY CHECKED | | |
| | NO. | | |

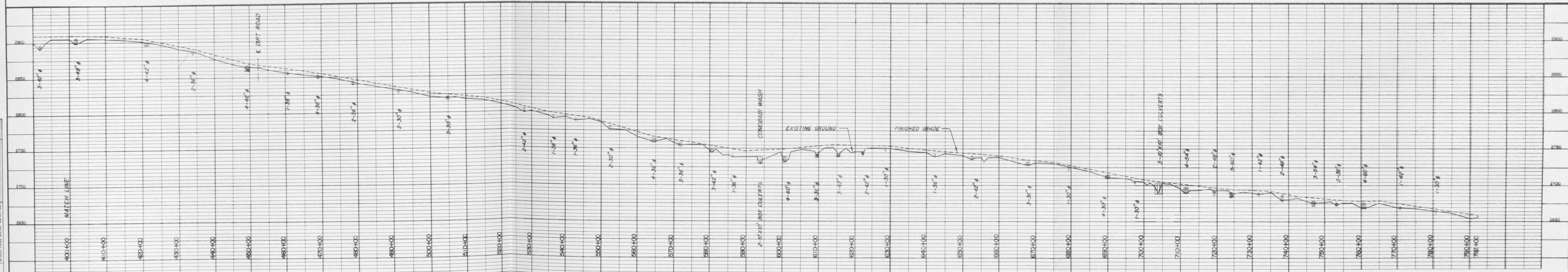

V L A SITE DEVELOPMENT STUDY
 FOR
THE ASSOCIATED UNIVERSITIES, INC.
PLAN & PROFILE
SOUTHWEST BRANCH
 SITE, Y-23, ARIZONA

DATE: SEPT. 1966 SCALE: Horiz. 1"=1000'
 Vert. 1"=50'

EXHIBIT 16

NOTE: THIS DRAWING IS NOT TO SCALE, IT HAS BEEN REDUCED FROM THE ORIGINAL.

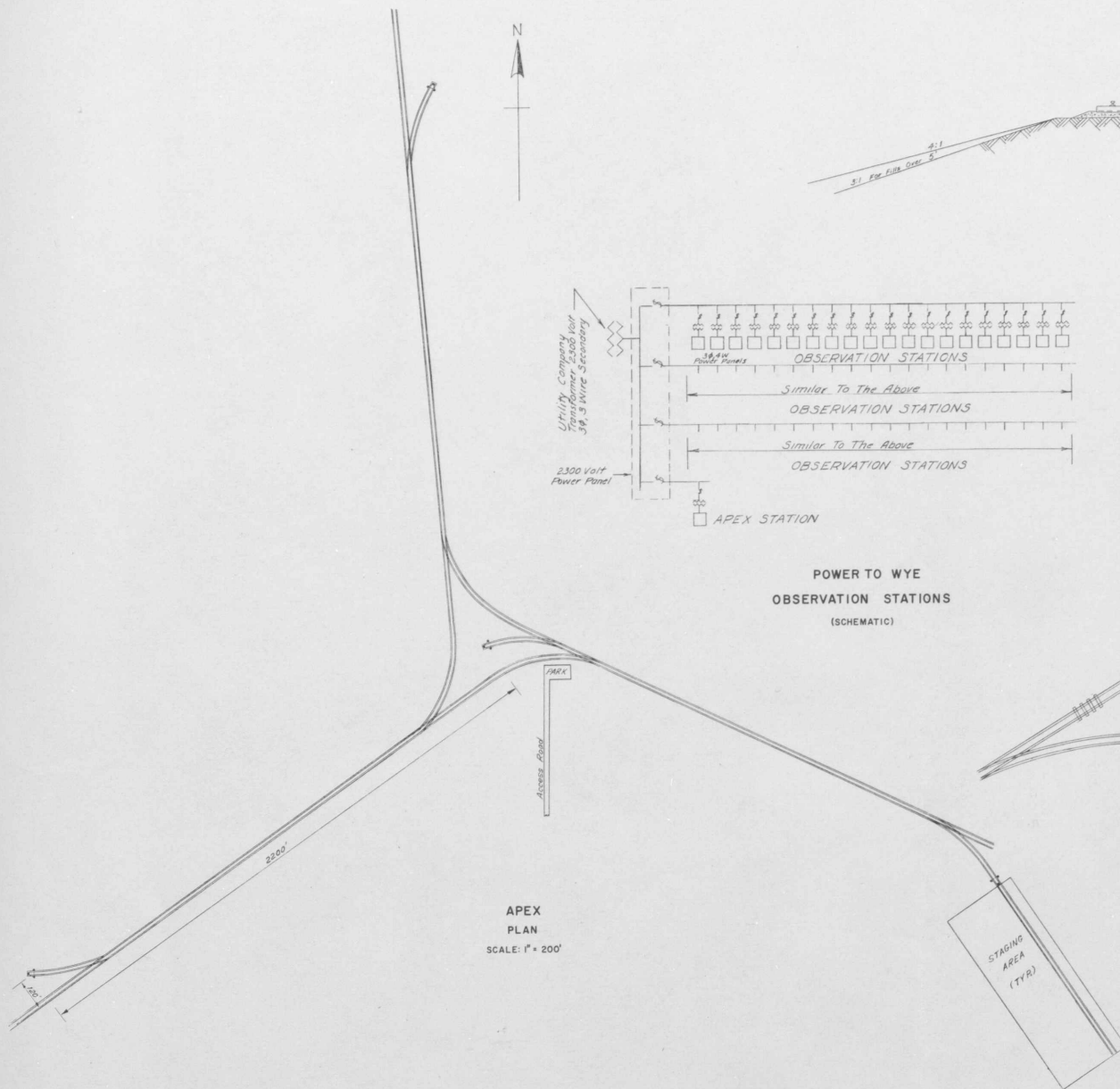

APEX
PLAN
SCALE: 1" = 200'

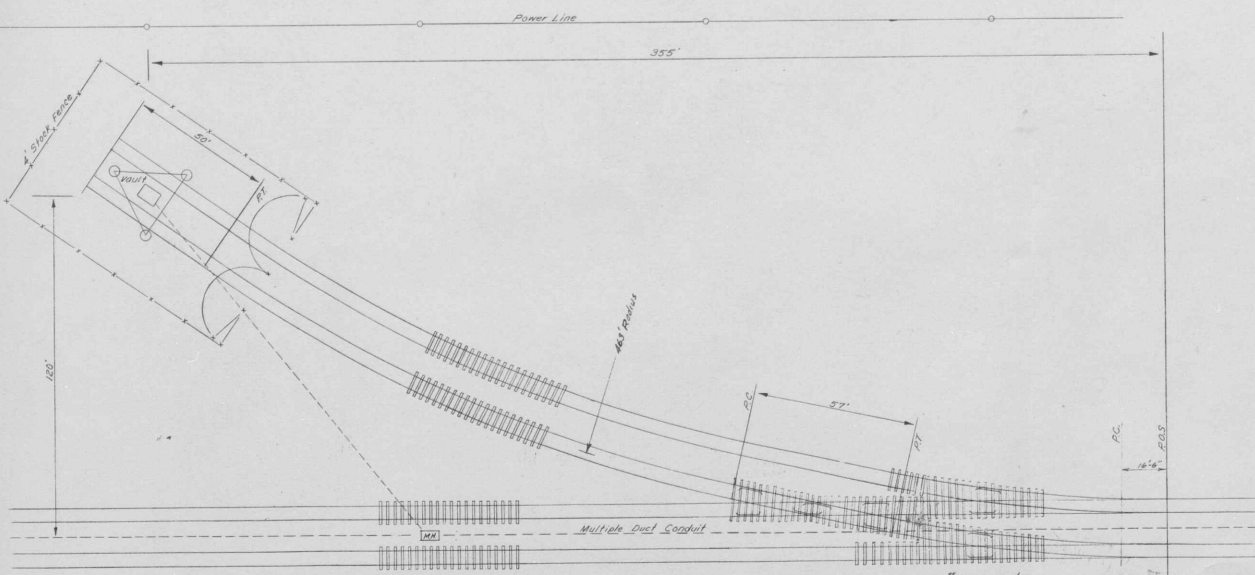

TYPICAL SPUR
PLAN
SCALE: 1" = 20'

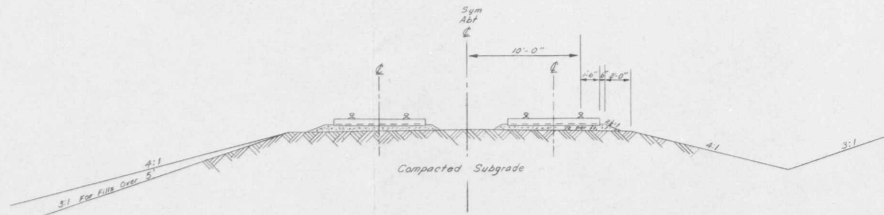

RAILWAY
TYPICAL SECTION
SCALE: 1" = 5'

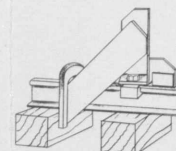

RAILWAY STOP
(NOT TO SCALE)

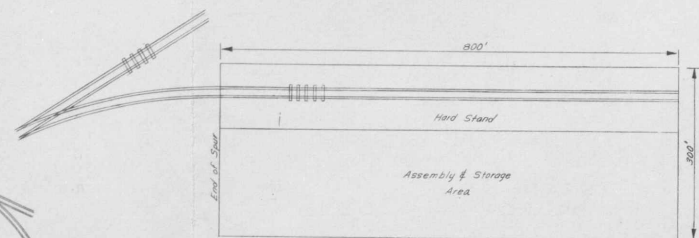

STAGING AREA
SCALE: 1" = 100'

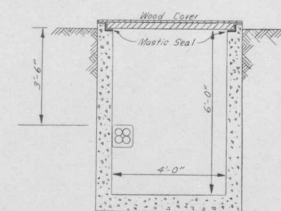

MANHOLE
SECTION A-A
SCALE: 1" = 2'

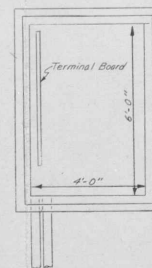

VAULT
PLAN VIEW
SCALE: 1" = 2'

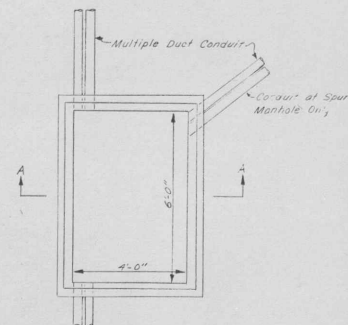

MULTIPLE DUCT CONDUIT
MANHOLE
PLAN VIEW
SCALE: 1" = 2'

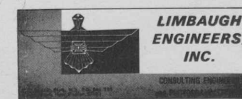

V L A SITE DEVELOPMENT STUDY
FOR
THE ASSOCIATED UNIVERSITIES, INC.
RAILWAY PLAN & DETAILS

DATE: SEPT. 1968 SCALE: AS SHOWN EXHIBIT 17

NOTE: THIS DRAWING IS NOT TO SCALE. IT HAS BEEN REDUCED FROM THE ORIGINAL.

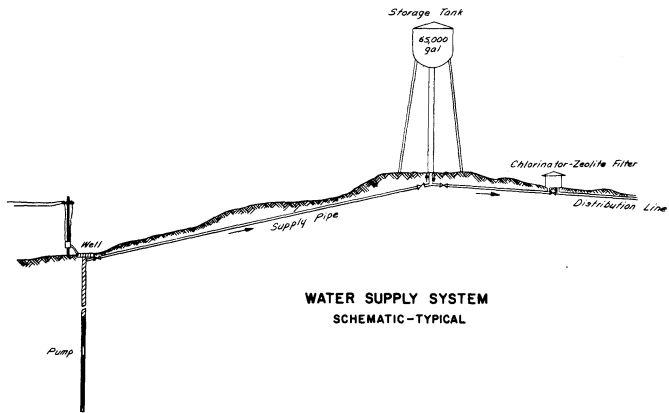

**WATER SUPPLY SYSTEM
SCHEMATIC-TYPICAL**

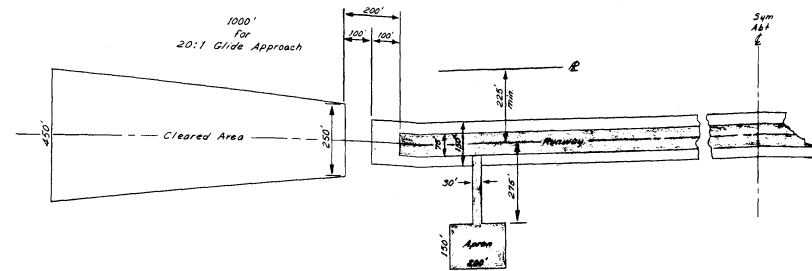

**AIRSTRIP
PLAN TYPICAL
SCALE: 1" = 200'**

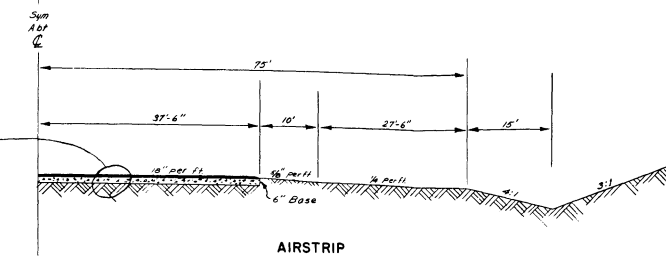
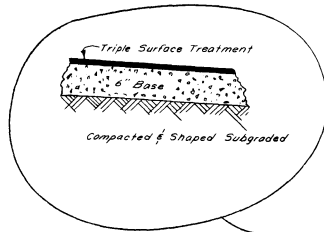

**AIRSTRIP
TYPICAL SECTION
SCALE: 1" = 10'**

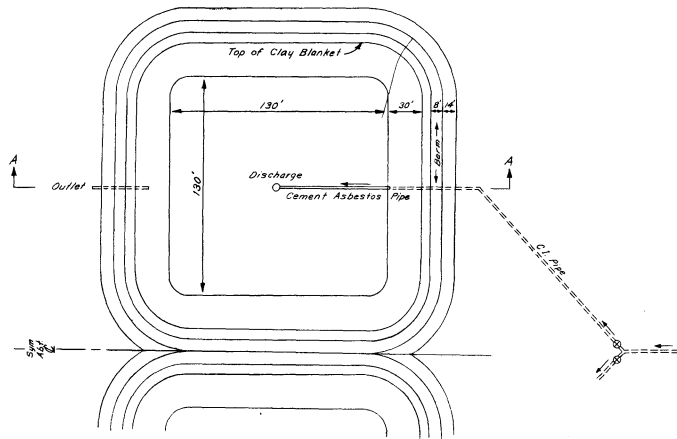

**SEWAGE LAGOONS
PLAN
(NOT TO SCALE)**

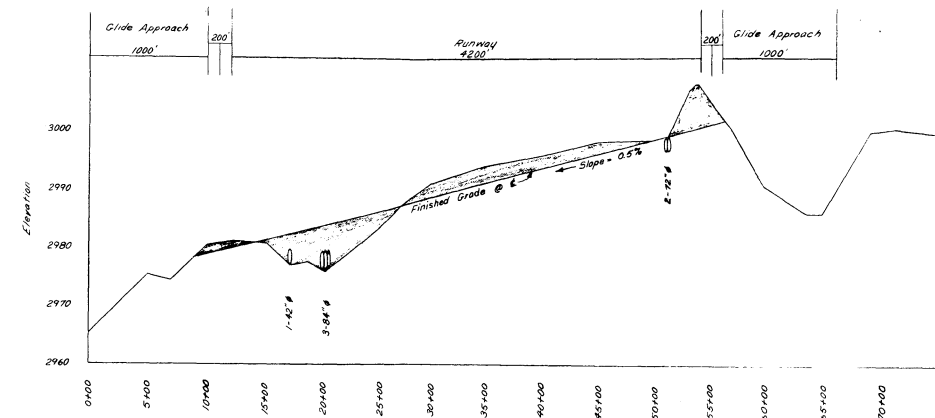

**Y23
AIRSTRIP
PROFILE**

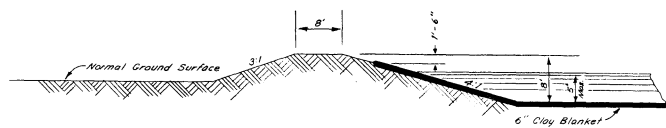

**LAGOON BERM
TYPICAL SECTION
(NOT TO SCALE)**



**SEWAGE LAGOON
SECTION A-A**

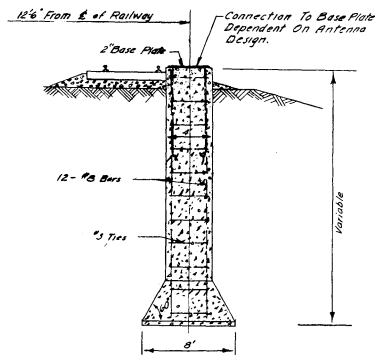

**OBSERVATION STATION FOUNDATION
TYPICAL SECTION
(NOT TO SCALE)**

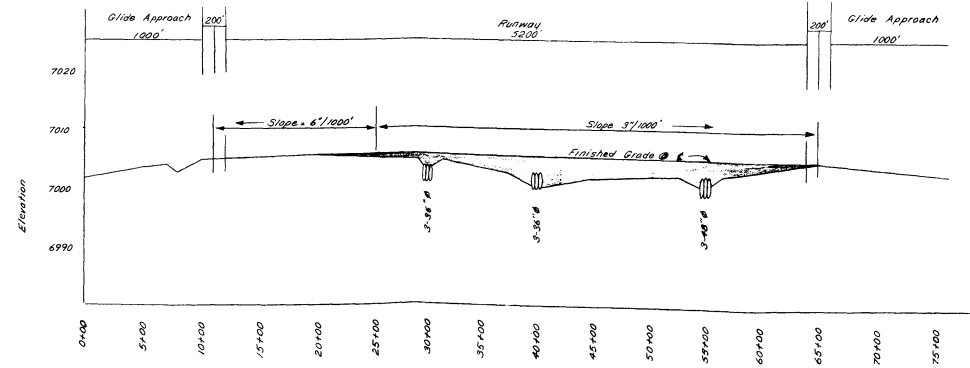

**Y15
AIRSTRIP
PROFILE**

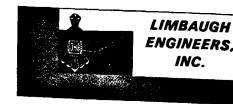

VLA SITE DEVELOPMENT STUDY
FOR
THE ASSOCIATED UNIVERSITIES, INC.

TYPICAL SECTIONS

DATE: SEP. 1958 SCALE: AS SHOWN **EXHIBIT 18**

NOTE: THIS DRAWING IS NOT TO SCALE. IT HAS BEEN REDUCED FROM THE ORIGINAL.

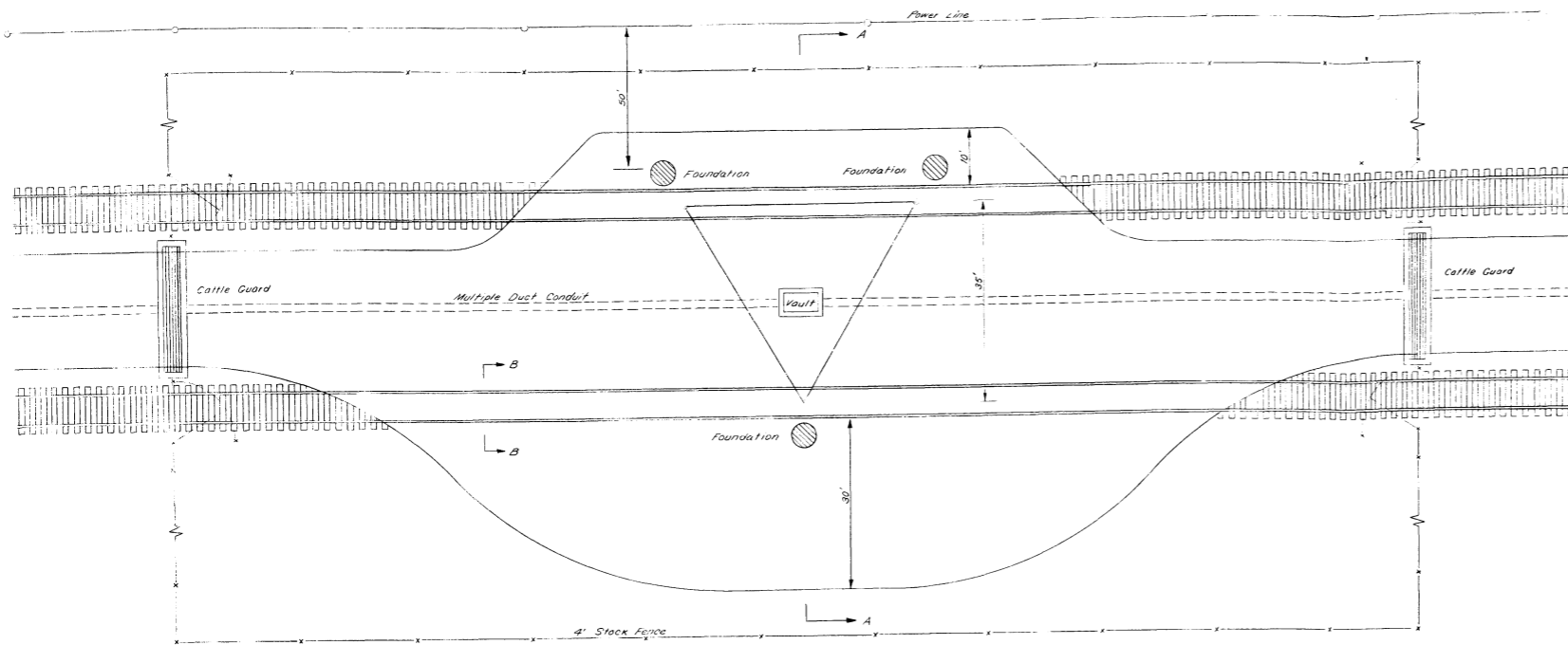

OBSERVATION STATION
TYPICAL PLAN
SCALE: 1" = 10'
ALTERNATE I

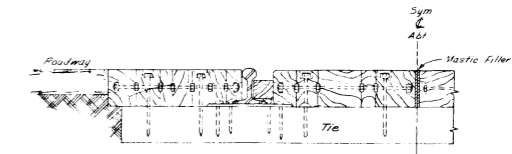

RAILWAY CROSSING
SECTION A-A

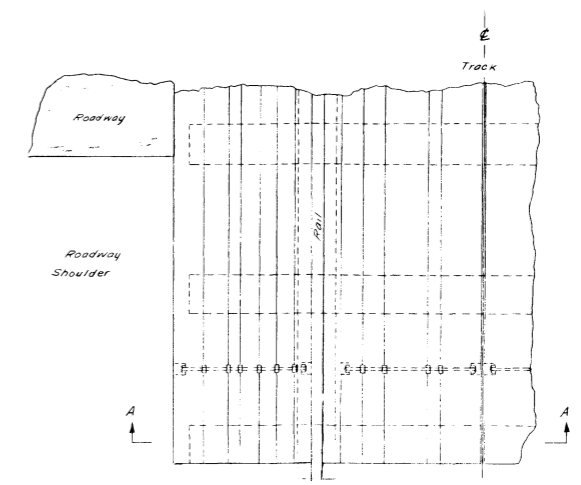

PREFABRICATED SECTIONAL TREATED
TIMBER RAILWAY CROSSING
(NOT TO SCALE)

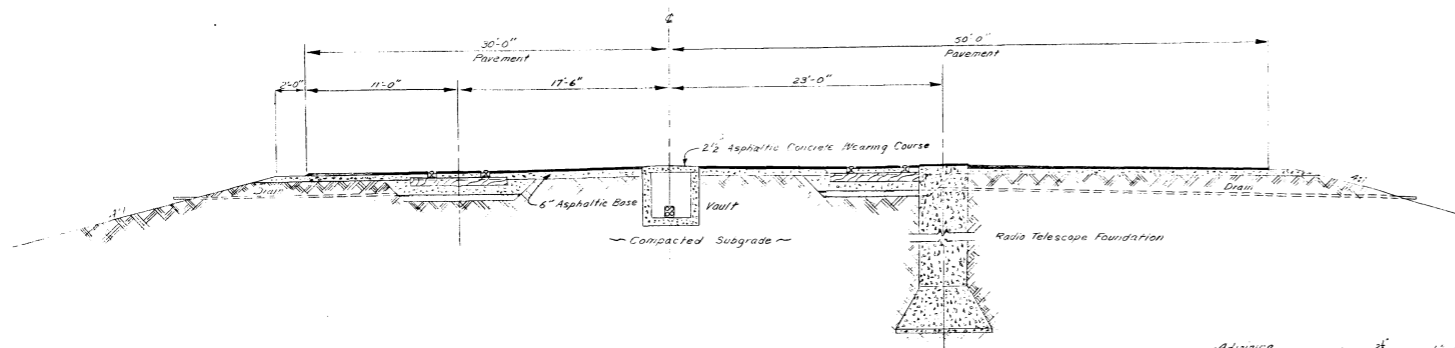

OBSERVATION STATION
SECTION A-A
SCALE: 1" = 5'
ALTERNATE I

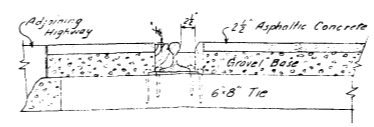

BITUMINOUS RAILWAY CROSSING
TYPICAL
(NOT TO SCALE)

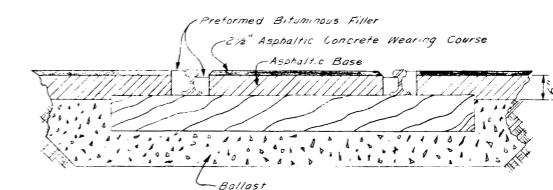

OBSERVATION STATION
SECTION B-B
(NOT TO SCALE)
ALTERNATE I

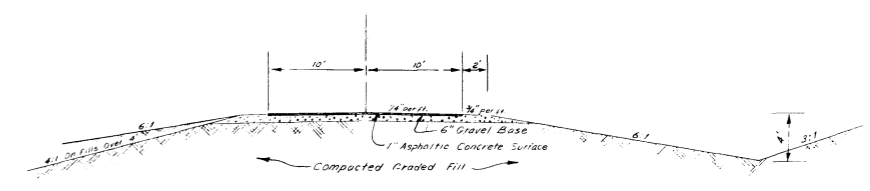

ACCESS ROAD
TYPICAL SECTION
(NOT TO SCALE)

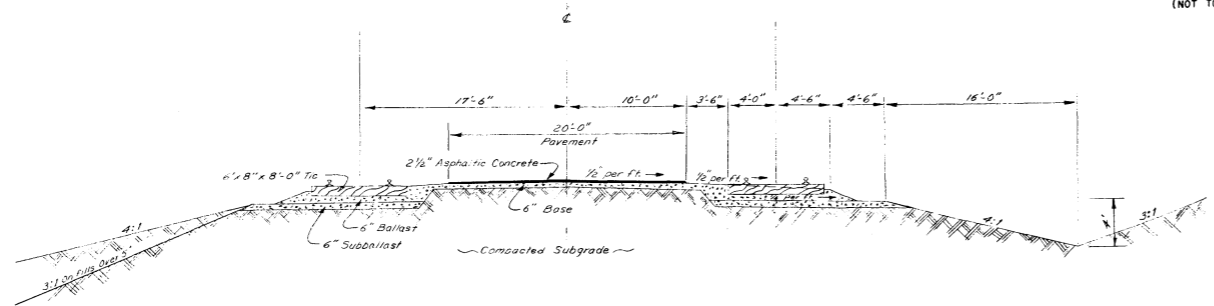

RAILWAY
TYPICAL SECTION
SCALE: 1" = 5'
ALTERNATE I

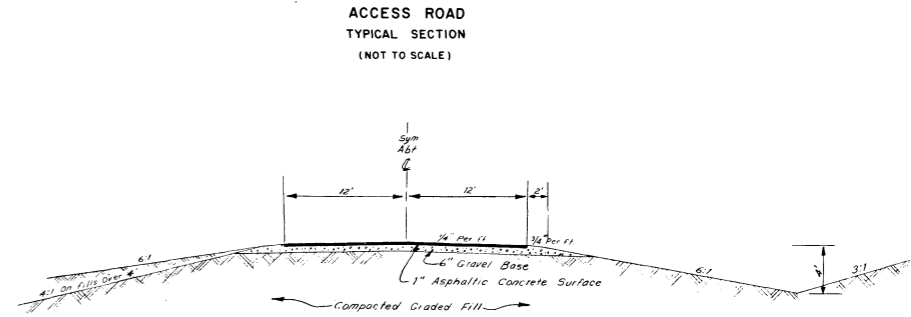

ENTRANCE ROAD
TYPICAL SECTION
(NOT TO SCALE)

V L A SITE DEVELOPMENT STUDY
FOR
THE ASSOCIATED UNIVERSITIES, INC.



ALTERNATE NO. 1 & SECTIONS

DATE: NOV. 1966 SCALE: AS SHOWN EXHIBIT 19

NOTE: THIS DRAWING IS NOT TO SCALE. IT HAS BEEN REDUCED FROM THE ORIGINAL.

TO ARRAY

PUBLIC PARKING

PERSONNEL PARKING

RESIDENT PARKING

DIRECTOR

DORMITORY

LABORATORY

OFFICE BUILDING

PAVED SERVICE AREA

GARAGES

SHOPS BUILDING

ELECTRIC EQUIPMENT ROOM

CONTROL & ELECTRONIC EQUIPMENT

RAMP



BUILDING COMPLEX PLOT PLAN

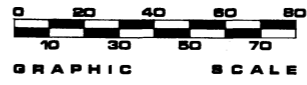

PERENCE, STYONS
GALLERY & PEARL
ARCHITECTS-ENGINEERS
ALBUQUERQUE

| | | |
|-----------------------------------|--------------------|------------|
| V L A SITE DEVELOPMENT STUDY | | |
| FOR | | |
| THE ASSOCIATED UNIVERSITIES, INC. | | |
| BUILDING COMPLEX PLOT PLAN | | |
| DATE: SEPT. 1964 | SCALE: 1" = 20'-0" | EXHIBIT 20 |

NOTE: THIS DRAWING IS NOT TO SCALE, IT HAS BEEN DRAWN TO THE GENERAL APPEARANCE

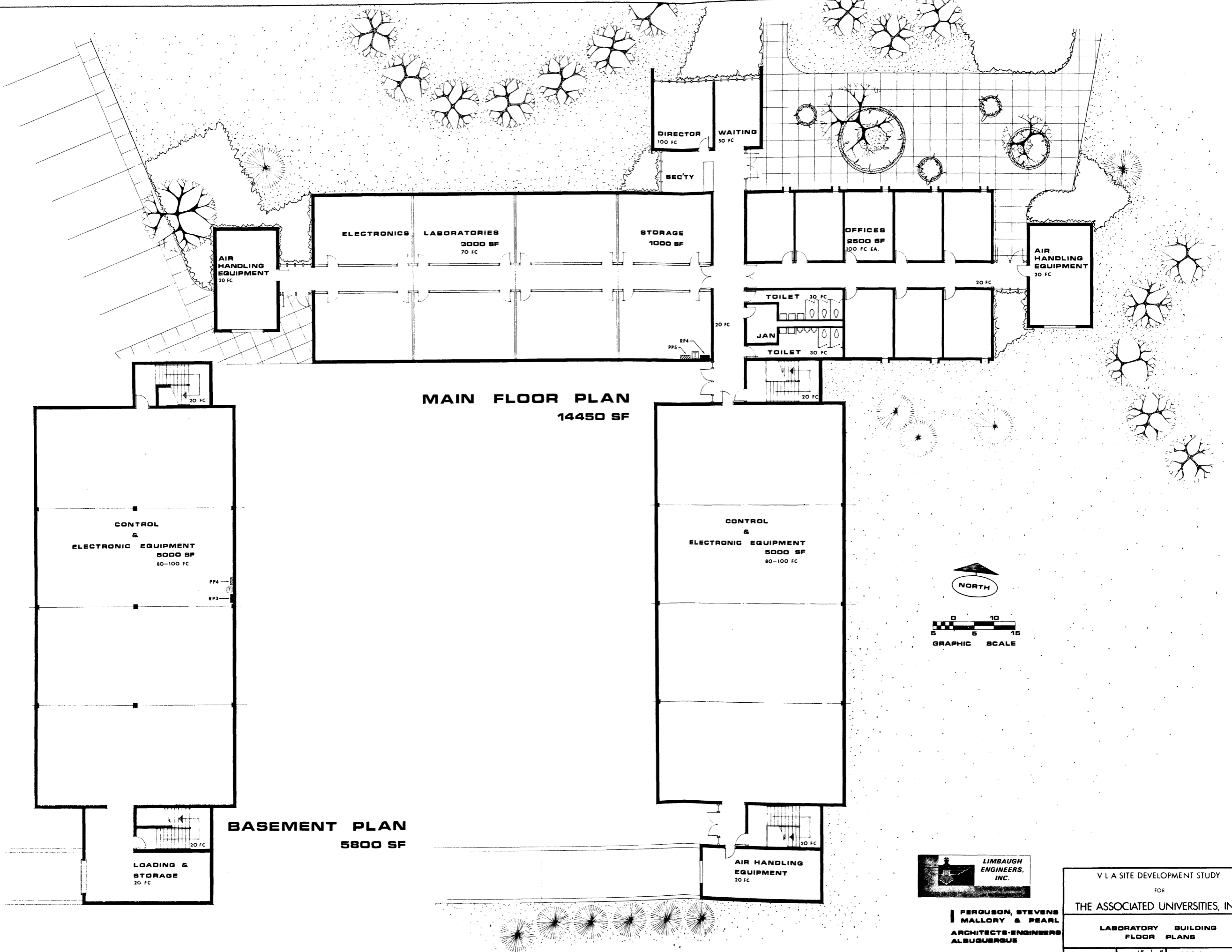

MAIN FLOOR PLAN
14450 SF

AIR HANDLING EQUIPMENT
20 FC

ELECTRONICS

LABORATORIES
3000 SF
70 FC

STORAGE
1000 SF

DIRECTOR
100 FC

WAITING
50 FC

SEC'TY

OFFICES
2500 SF
100 FC EA.

AIR HANDLING EQUIPMENT
20 FC

TOILET
30 FC

JAN

TOILET
30 FC

PP4

PP5

20 FC

20 FC

CONTROL
&
ELECTRONIC EQUIPMENT
5000 SF
80-100 FC

PP4

RP3

CONTROL
&
ELECTRONIC EQUIPMENT
5000 SF
80-100 FC

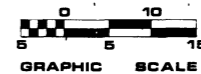

BASEMENT PLAN
5800 SF

LOADING &
STORAGE
20 FC

20 FC

AIR HANDLING EQUIPMENT
20 FC

20 FC



**FERGUSON, STEVENS
MALLORY & PEARL**
ARCHITECTS-ENGINEERS
ALBUQUERQUE

| | | |
|-----------------------------------|---------------------|------------|
| V L A SITE DEVELOPMENT STUDY | | |
| FOR | | |
| THE ASSOCIATED UNIVERSITIES, INC. | | |
| LABORATORY BUILDING FLOOR PLANS | | |
| DATE: SEPT. 1964 | SCALE: 1/4" = 1'-0" | EXHIBIT 21 |

NOTE: THIS DRAWING IS NOT TO SCALE. IT HAS BEEN REDUCED FROM THE ORIGINAL.

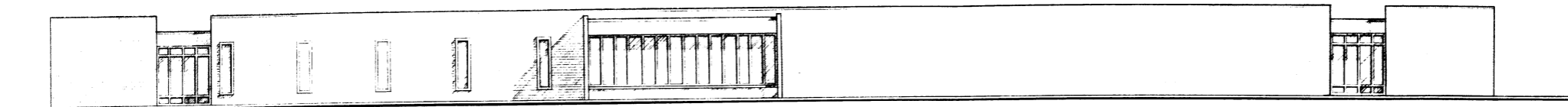

NORTH ELEVATION

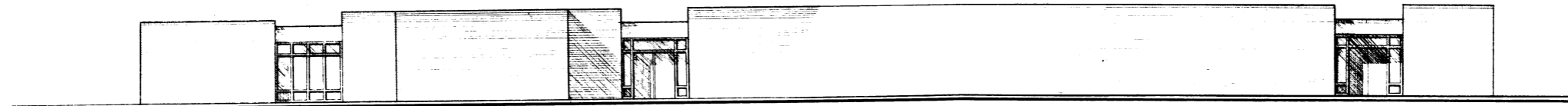

WEST ELEVATION

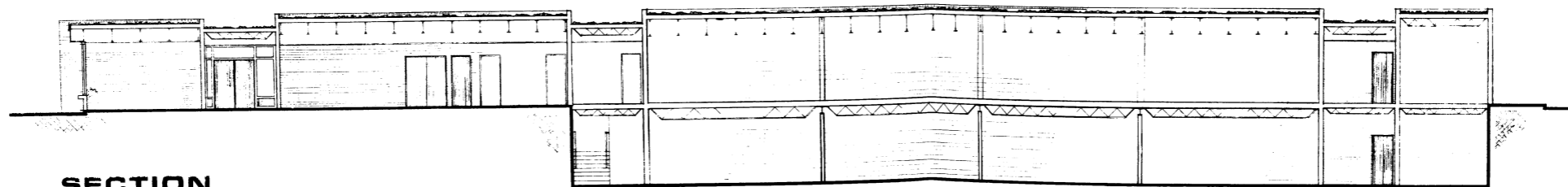

SECTION



**FERGUSON, STEVENS
MALLORY & PEARL
ARCHITECTS-ENGINEERS
ALBUQUERQUE**

| | | |
|--|---------------------------------|------------|
| V L A SITE DEVELOPMENT STUDY FOR THE ASSOCIATED UNIVERSITIES, INC. | | |
| LABORATORY BUILDING ELEVATIONS & SECTION | | |
| DATE: SEPT. 1966 | SCALE: $\frac{1}{8}'' = 1'-0''$ | EXHIBIT 22 |

NOTE: THIS DRAWING IS NOT TO SCALE, IT HAS BEEN REDUCED FROM THE ORIGINAL.

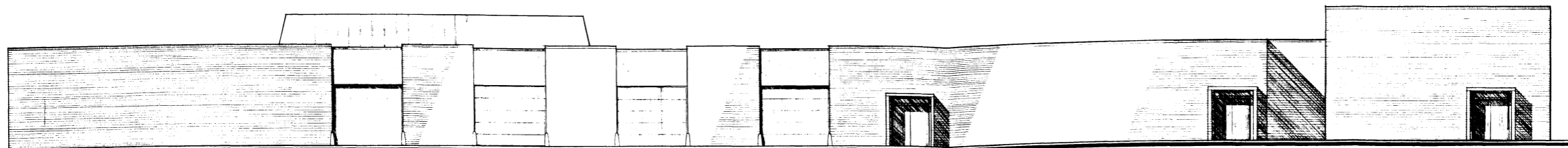

SOUTH ELEVATION

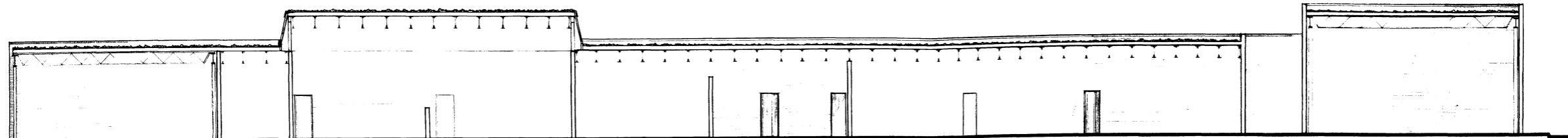

LONGITUDINAL SECTION

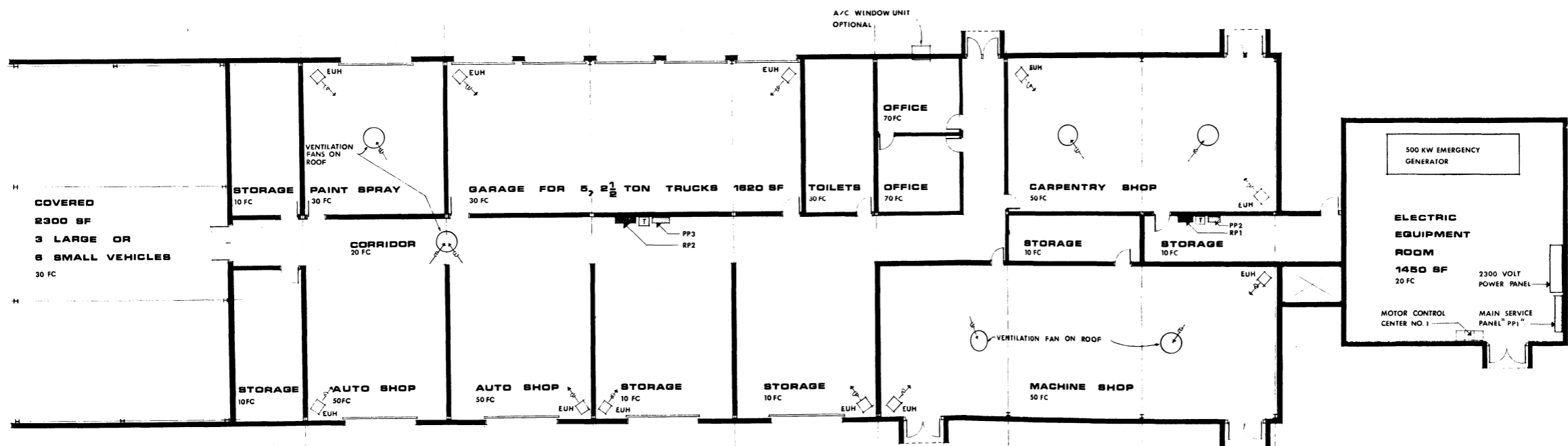

FLOOR PLAN 13670 SF

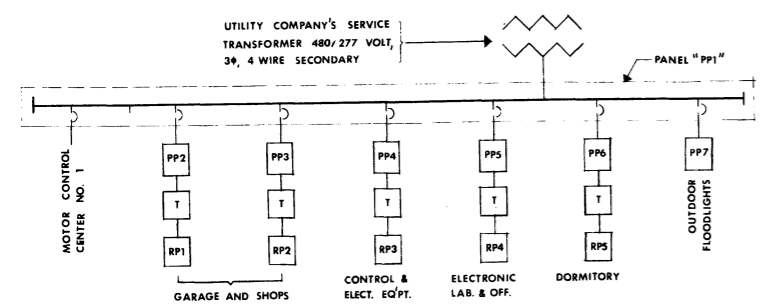

ELECTRIC DIAGRAM

- ▨ 480/277 V, 3Φ, 4W PANELBOARD
- ⊞ 480/120/208 V, 3Φ, 4W TRANSFORMER
- ▬ 120/208 V, 3Φ, 4W PANELBOARD

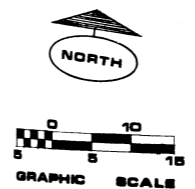

V L A SITE DEVELOPMENT STUDY
FOR
THE ASSOCIATED UNIVERSITIES, INC.

SHOPS BUILDING, GARAGES,
& CENTRAL POWER PLANT
PLAN, ELEVATION & SECTION

DATE: 10-1-68 DRAWN: V.L.A. EXHIBIT 23

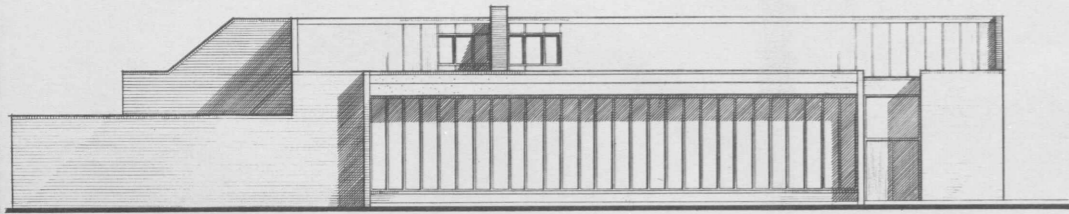

NORTH ELEVATION

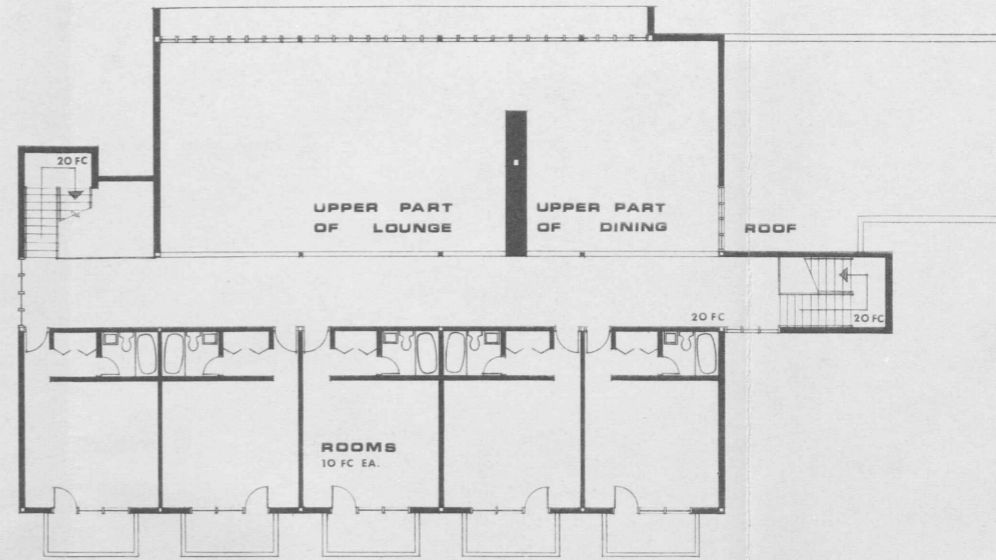

UPPER FLOOR PLAN 2800 SF



TOTAL AREA 7800 SF

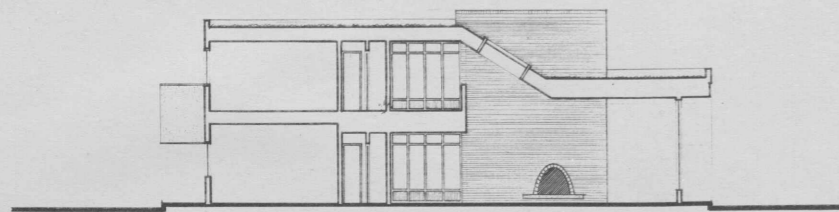

CROSS SECTION

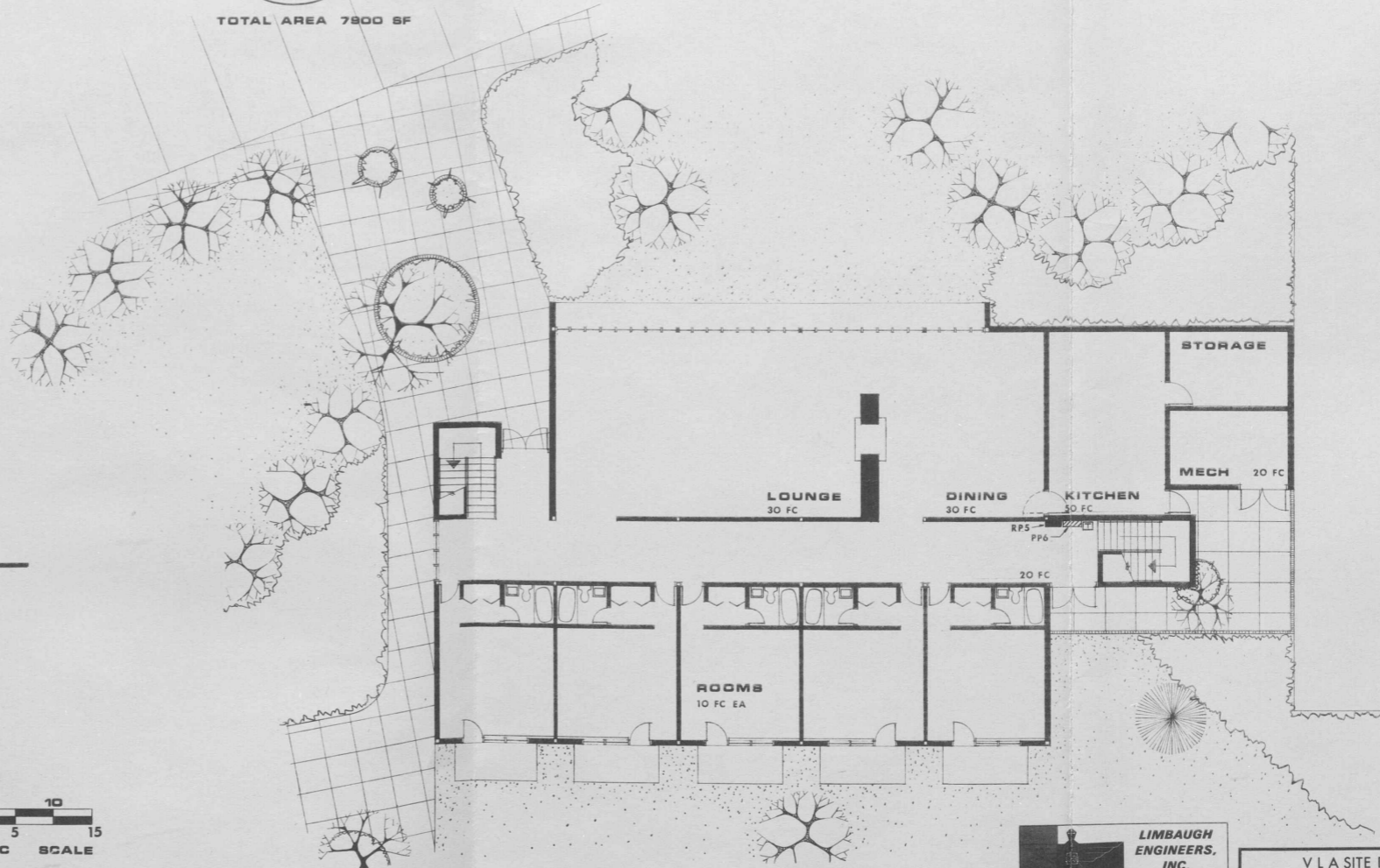

GROUND FLOOR PLAN 5100 SF

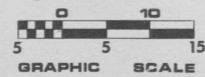

GRAPHIC SCALE

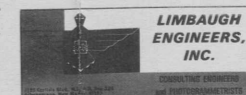

**FERGUSON, STEVENS
MALLORY & PEARL
ARCHITECTS-ENGINEERS
ALBUQUERQUE**

NOTE: THIS DRAWING IS NOT TO SCALE, IT HAS BEEN REDUCED FROM THE ORIGINAL.

| | |
|-----------------------------------|--------------------------------|
| V L A SITE DEVELOPMENT STUDY | |
| FOR | |
| THE ASSOCIATED UNIVERSITIES, INC. | |
| DORMITORY BUILDING | |
| PLAN ELEVATION & SECTION | |
| DATE: SEPT. 1964 | SCALE: 1/4" = 1'-0" EXHIBIT 24 |