

VERTEX

50% TO VERTEX

BOTTOM OF B.U.S.

1/8 MOUNTING PLATE
(31 x 64 1/2)

ELEV. VIEW
(ALL MEMBERS
TO BE 3x3 ANGLES.)

RECEIVER MOUNTING ASSY (BRACINGS NOT SHOWN)
POS. (1) & (2)
(SCALE 1/8)

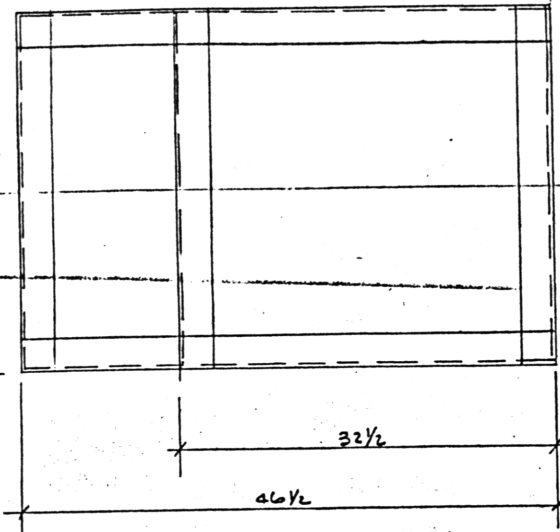

1/8" MOUNTING PL
(31 x 46 1/2)

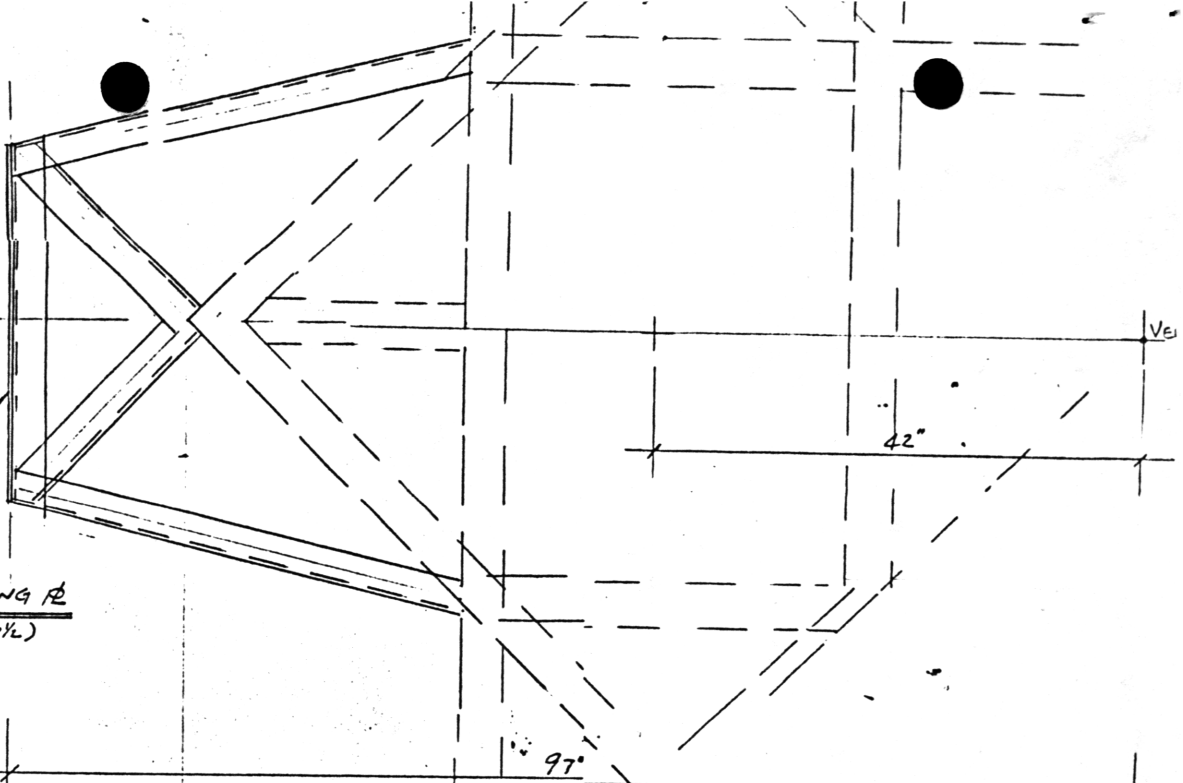

RECEIVER MOUNTING ASSY (BRACINGS NOT SHOWN)

POS. (3) & (4)

(SCALE 1/8)

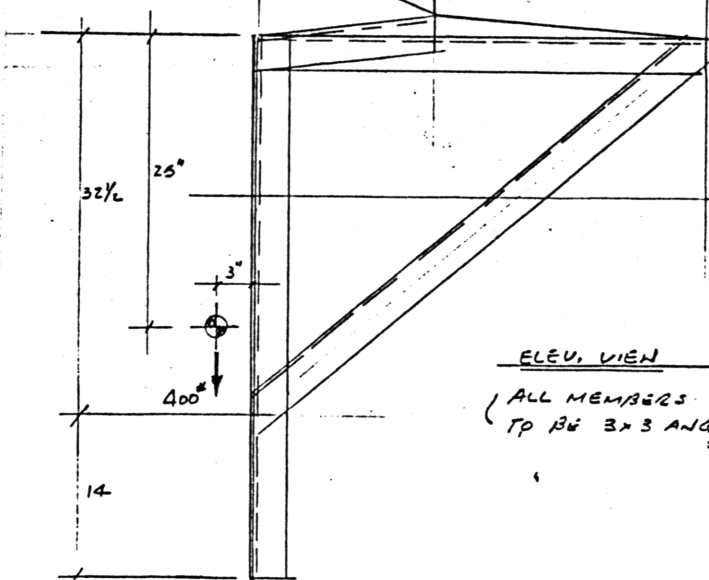

ELEV. VIEW
(ALL MEMBERS TO BE 3 x 3 ANGLES)

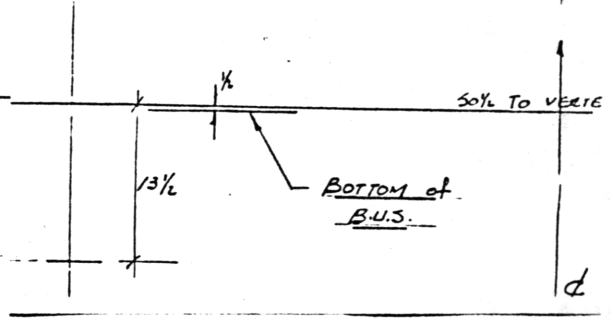

RECEIVER MOUNTING STRUC.

w.r.t. HuB

